

1. PART NO. EXPRESSION :

P D H 5 0 2 2 R 7 8 M Z F
 (a) (b) (c) (d)(e)(f)

(a) Series code

(d) Tolerance code : M = ±20%

(b) Dimension code

(e) Z : Standard part

(c) Inductance code : R78 = 0.78uH

(f) F : RoHS Compliant

2. CONFIGURATION & DIMENSIONS :

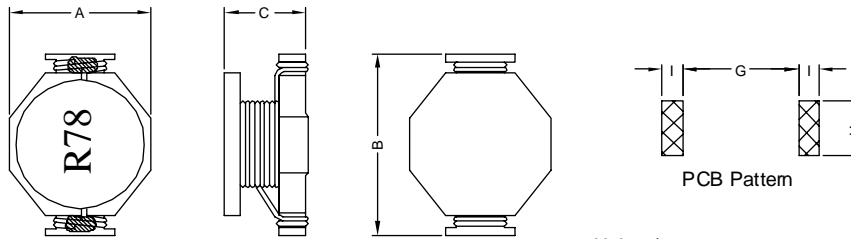

A	B	C	G	H	I
16.26 Max.	22.35 Max.	8.00 Max.	14.35 Ref.	8.64 Ref.	3.18 Ref.

3. SCHEMATIC :



4. MATERIALS :

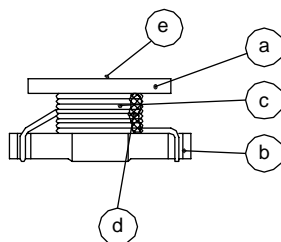

(a) Core

(b) Base

(c) Wire

(d) Adhesive

(e) Ink

5. GENERAL SPECIFICATION :

- a) Temp. rise : 40° C Typ.
- b) Isat : L/LOA = 10% Typ.
- c) Operating temp. : -40° C to +85° C
- d) Storage condition (component in its packaging)
 - i) Temperature : -10 to 40° C
 - ii) Humidity : 60%
- e) Resistance to solder heat : 260° C.10 secs



RoHS Compliant

NOTE : Specifications subject to change without notice. Please check our website for latest information.

25.11.2014



SUPERWORLD ELECTRONICS (S) PTE LTD

6. ELECTRICAL CHARACTERISTICS :

Part No.	Inductance (μ H)	Test Freq. (Hz)	SRF (MHz) Typ.	RDC (m Ω) Max.	Isat (A)	Irms (A)
PDH5022R78MZF	0.78 \pm 20%	0.1V/100K	156	2.6	30.0	15.0
PDH50221R5MZF	1.50 \pm 20%	0.1V/100K	100	4.0	25.0	15.0
PDH50222R2MZF	2.20 \pm 20%	0.1V/100K	75	6.1	20.0	12.0
PDH50223R3MZF	3.30 \pm 20%	0.1V/100K	60	8.6	17.0	10.0
PDH50223R9MZF	3.90 \pm 20%	0.1V/100K	55	10.0	15.0	9.0
PDH50224R7MZF	4.70 \pm 20%	0.1V/100K	40	14.0	13.0	8.4
PDH50226R0MZF	6.00 \pm 20%	0.1V/100K	35	17.0	12.0	7.5
PDH50227R8MZF	7.80 \pm 20%	0.1V/100K	35	18.0	11.0	7.5
PDH5022100MZF	10.00 \pm 20%	0.1V/100K	28	26.0	10.0	6.0
PDH5022150MZF	15.00 \pm 20%	0.1V/100K	20	32.0	8.0	4.4



RoHS Compliant

NOTE : Specifications subject to change without notice. Please check our website for latest information.

25.11.2014



SUPERWORLD ELECTRONICS (S) PTE LTD

PG. 2

7. CHARACTERISTICS CURVES :

@ TEMP. RISE VS. DC SUPERPOSITION RESPONSE CURVE

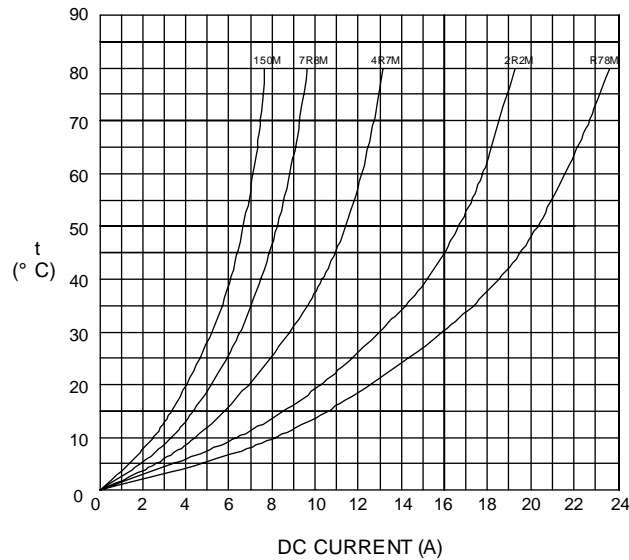

@ INDUCTANCE VS. FREQUENCY RESPONSE CURVE

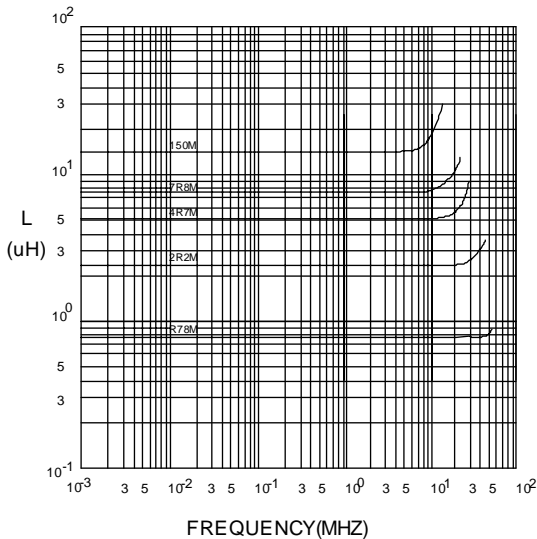

@ INDUCTANCE VS. DC SUPERPOSITION RESPONSE CURVE

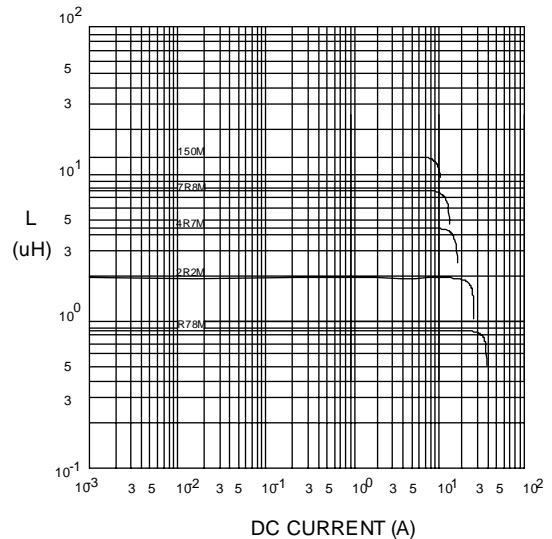

NOTE : Specifications subject to change without notice. Please check our website for latest information.



RoHS Compliant

25.11.2014



SUPERWORLD ELECTRONICS (S) PTE LTD

RECOMMENDED SOLDERING CONDITIONS REFLOW SOLDERINGS

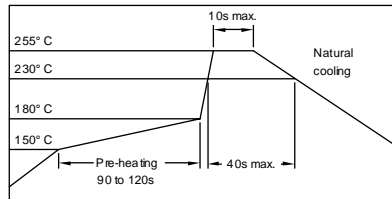

8. PACKAGING INFORMATION :

(1) CONFIGURATION

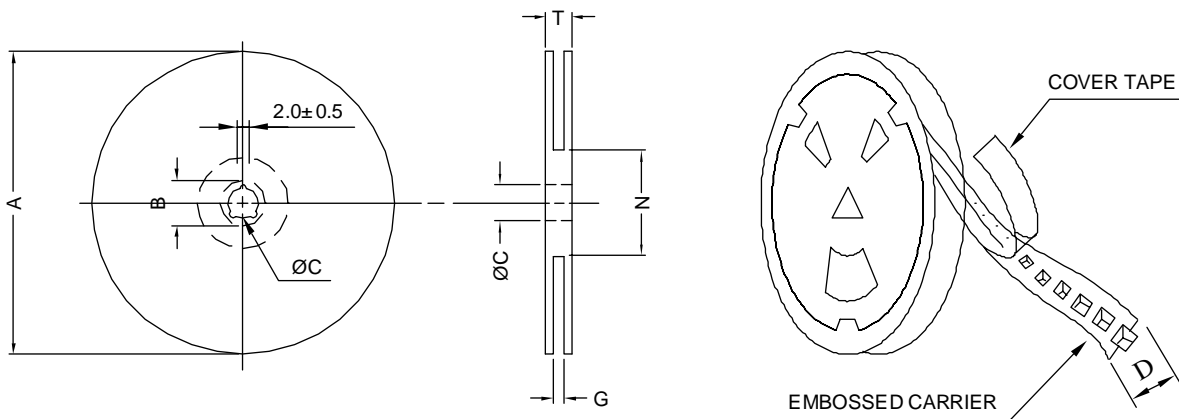

* CARRIER TAPE WIDTH : D

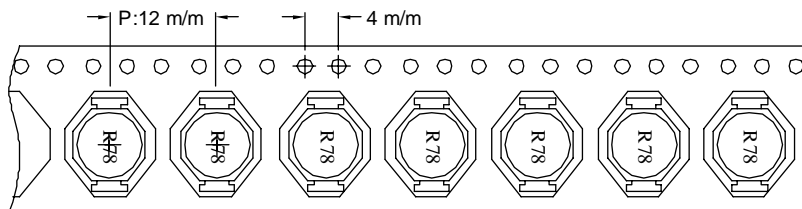

(2) DIMENSIONS

Unit:m/m

STYLE	A	B	C	D	G	N	T
13-32	330	21±0.8	13±0.5	32	34 ⁺⁰	100 ⁻⁰	38.4

(3) QTY & G.W. PER PACKAGE

SERIES	INNER : REEL			OUTER : CARTON		
	QTY (PCS)	G.W. (gw)	STYLE	QTY (PCS)	G.W. (Kg)	SIZE (cm)
PDH5022	250	1250	13-32	1000	8.5	38 x 36.5 x 21



RoHS Compliant

NOTE : Specifications subject to change without notice. Please check our website for latest information.

25.11.2014



SUPERWORLD ELECTRONICS (S) PTE LTD