

1. PART NO. EXPRESSION :

PSB0603 - 101 KZF
 (a) (b) (c) (d)(e)(f)

(a) Series code

(b) Dimension code

(c) Inductance code : 101 = 100uH

(d) Tolerance code : K = ± 10%, M = ± 20%

(e) Z : Standard part

(f) F : RoHS Compliant

2. CONFIGURATION & DIMENSIONS :

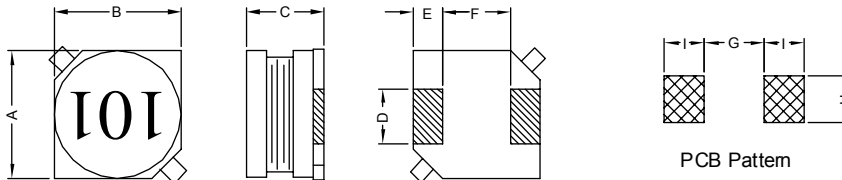

Unit:m/m

A	B	C	D	E	F	G	H	I
6.0±0.3	6.0±0.3	2.9±0.3	2.0±0.2	1.5±0.2	3.0±0.2	2.8 Ref.	2.2 Ref.	1.9 Ref.

3. SCHEMATIC :



4. MATERIALS :

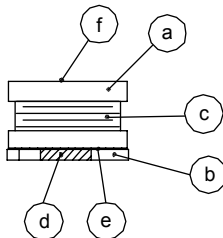

(a) Core

(b) Base

(c) Wire

(d) Terminal

(e) Adhesive

(f) Ink

5. GENERAL SPECIFICATION :

- a) Temp. rise : 40° C Max.
- b) Rated current : Base on temp. rise & ΔL/L0A = 10% Max.
- c) Operating temp. : -40° C to +85° C
- d) Storage condition (component in its packaging)
 - i) Temperature : -10 to 40° C
 - ii) Humidity : 60%
- e) Resistance to solder heat : 260° C.10 secs



RoHS Compliant

NOTE : Specifications subject to change without notice. Please check our website for latest information.

06.01.2015



SUPERWORLD ELECTRONICS (S) PTE LTD

6. ELECTRICAL CHARACTERISTICS :

Part No.	Inductance (μ H)	Q Ref.	Test Frequency (Hz)	SRF (MHz) Typ.	RDC (m Ω) Max.	IDC (A) Max.
PSB06031R2MZF	1.2 \pm 20%	30	1V / 100K	150.0	25	2.80
PSB06031R5MZF	1.5 \pm 20%	30	1V / 100K	135.0	28	2.60
PSB06032R2MZF	2.2 \pm 20%	30	1V / 100K	85.0	30	2.30
PSB06033R3MZF	3.3 \pm 20%	30	1V / 100K	70.0	55	2.00
PSB06034R7MZF	4.7 \pm 20%	25	1V / 100K	60.0	65	1.85
PSB06036R8MZF	6.8 \pm 20%	30	1V / 100K	45.0	90	1.65
PSB0603100MZF	10.0 \pm 20%	25	1V / 100K	35.0	115	1.45
PSB0603120MZF	12.0 \pm 20%	30	1V / 100K	33.0	150	1.20
PSB0603150MZF	15.0 \pm 20%	25	1V / 100K	32.0	180	1.15
PSB0603180MZF	18.0 \pm 20%	30	1V / 100K	30.0	230	1.05
PSB0603220MZF	22.0 \pm 20%	30	1V / 100K	28.0	250	1.00
PSB0603270MZF	27.0 \pm 20%	30	1V / 100K	27.0	350	0.95
PSB0603330KZF	33.0 \pm 10%	35	1V / 100K	22.0	380	0.90
PSB0603390KZF	39.0 \pm 10%	25	1V / 100K	20.0	410	0.80
PSB0603470KZF	47.0 \pm 10%	40	1V / 100K	16.0	430	0.75
PSB0603560KZF	56.0 \pm 10%	40	1V / 100K	15.0	620	0.70
PSB0603680KZF	68.0 \pm 10%	40	1V / 100K	13.0	710	0.60
PSB0603820KZF	82.0 \pm 10%	50	1V / 100K	11.0	730	0.50
PSB0603101KZF	100.0 \pm 10%	45	1V / 100K	10.0	1050	0.48
PSB0603121KZF	120.0 \pm 10%	40	1V / 100K	9.5	1180	0.45
PSB0603151KZF	150.0 \pm 10%	50	1V / 100K	9.0	1800	0.40
PSB0603181KZF	180.0 \pm 10%	50	1V / 100K	8.0	1950	0.35
PSB0603221KZF	220.0 \pm 10%	55	1V / 100K	7.0	2960	0.30
PSB0603271KZF	270.0 \pm 10%	55	1V / 100K	6.5	3450	0.28
PSB0603331KZF	330.0 \pm 10%	50	1V / 100K	6.0	3800	0.26
PSB0603391KZF	390.0 \pm 10%	50	1V / 100K	5.0	4000	0.24
PSB0603471KZF	470.0 \pm 10%	60	1V / 100K	4.8	4400	0.22
PSB0603561KZF	560.0 \pm 10%	60	1V / 100K	4.4	6200	0.20
PSB0603681KZF	680.0 \pm 10%	60	1V / 100K	4.0	6800	0.18
PSB0603821KZF	820.0 \pm 10%	60	1V / 100K	3.8	12000	0.16
PSB0603102KZF	1000.0 \pm 10%	60	1V / 100K	3.5	13500	0.14

NOTE : Specifications subject to change without notice. Please check our website for latest information.

06.01.2015



7. CHARACTERISTICS CURVES :

@ TEMP. RISE VS. DC SUPERPOSITION RESPONSE CURVE

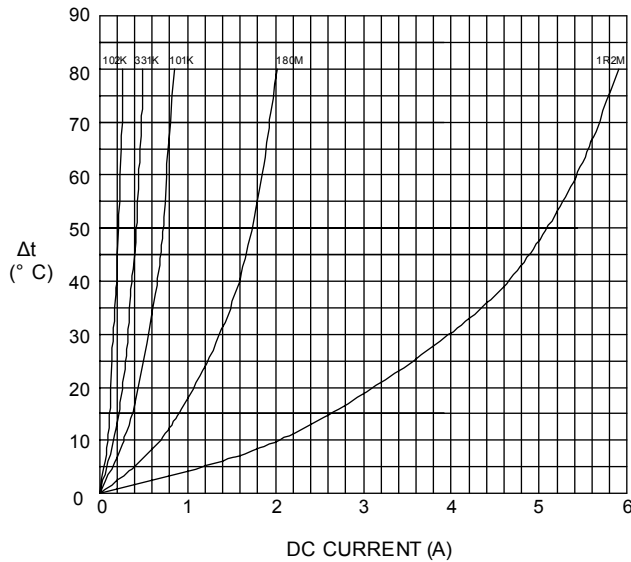

@ INDUCTANCE VS. FREQUENCY RESPONSE CURVE

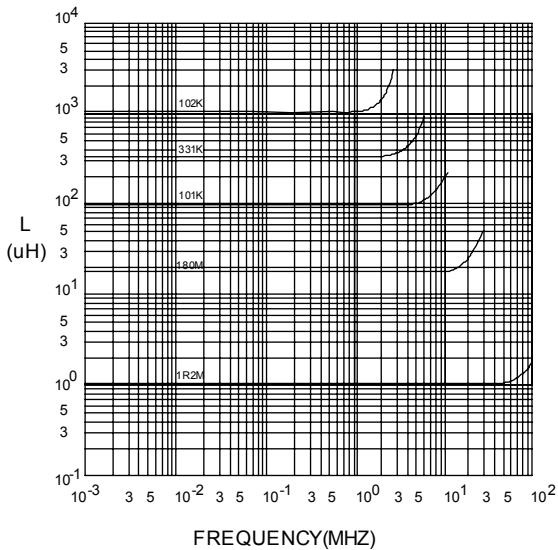

@ INDUCTANCE VS. DC SUPERPOSITION RESPONSE CURVE

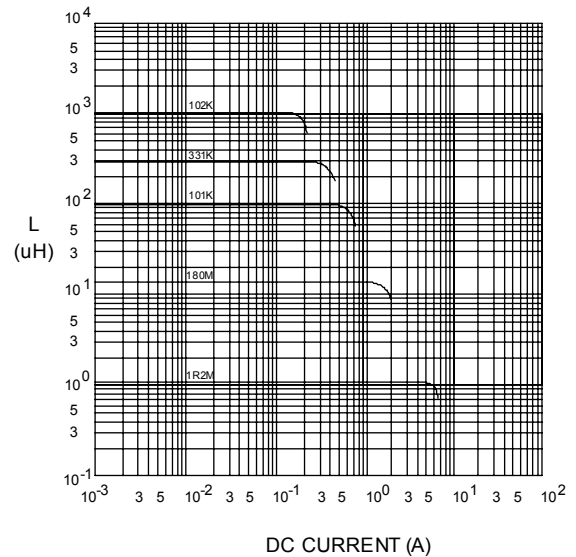

NOTE : Specifications subject to change without notice. Please check our website for latest information.



RoHS Compliant

06.01.2015



SUPERWORLD ELECTRONICS (S) PTE LTD

RECOMMENDED SOLDERING CONDITIONS REFLOW SOLDERINGS

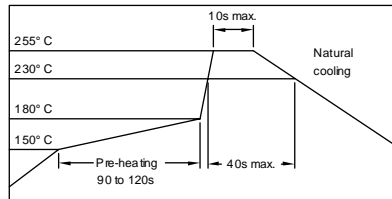

8. PACKAGING INFORMATION :

(1) CONFIGURATION

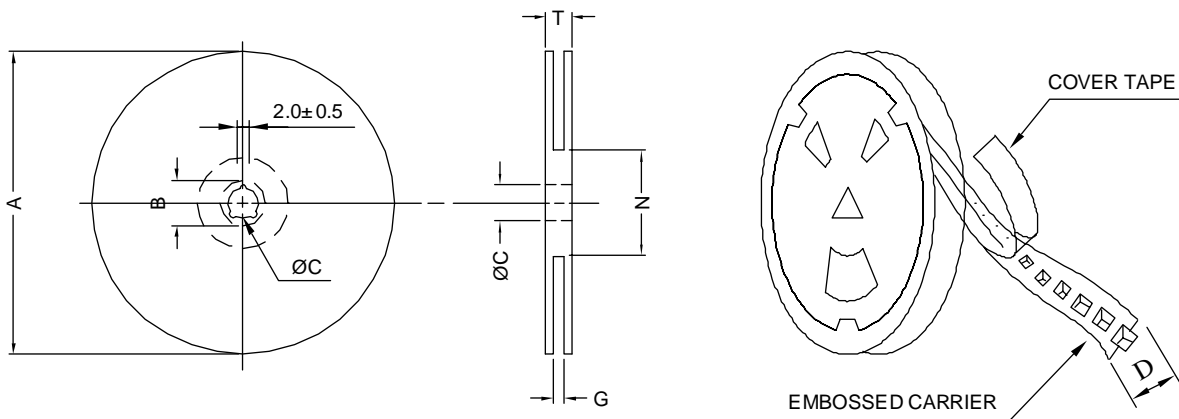

* CARRIER TAPE WIDTH : D

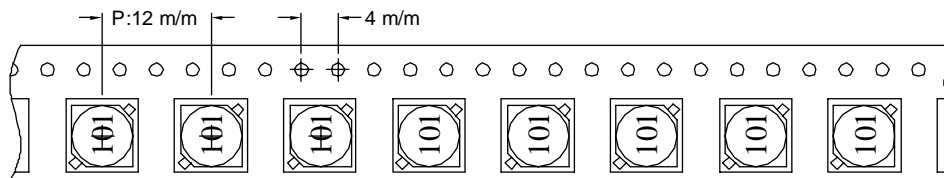

(2) DIMENSIONS

Unit:m/m

STYLE	A	B	C	D	G	N	T
13-16	330	21±0.8	13	16	18 ⁺⁰	50 ⁻⁰	22.4

(3) QTY & G.W. PER PACKAGE

SERIES	INNER : REEL			OUTER : CARTON		
	QTY (PCS)	G.W. (gw)	STYLE	QTY (PCS)	G.W. (Kg)	SIZE (cm)
PSB0603	1000	450	13-16	6000	6.2	40 x 40 x 24



RoHS Compliant

NOTE : Specifications subject to change without notice. Please check our website for latest information.

06.01.2015



SUPERWORLD ELECTRONICS (S) PTE LTD