

1. PART NO. EXPRESSION :

PSB 1003 101 K Z F
 (a) (b) (c) (d)(e)(f)

- (a) Series code
- (b) Dimension code
- (c) Inductance code : 101 = 100.0uH
- (d) Tolerance code : K = ± 10%, L = ± 15%, M = ± 20%
- (e) Z : Standard part
- (f) F : RoHS Compliant

2. CONFIGURATION & DIMENSIONS :

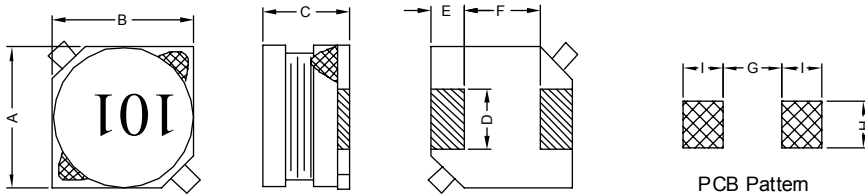

Unit:m/m

A	B	C	D	E	F	G	H	I
10.0±0.3	10.0±0.3	3.0±0.3	2.4±0.2	2.0±0.2	6.0±0.2	5.7 Ref.	2.8 Ref.	2.5 Ref.

3. SCHEMATIC :

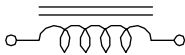

4. MATERIALS :

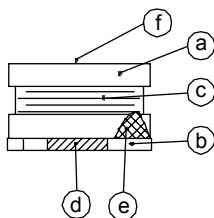

- (a) Core
- (b) Base
- (c) Wire
- (d) Terminal
- (e) Adhesive
- (f) Ink

5. GENERAL SPECIFICATION :

- a) Temp. rise : 40° C Max. at Rated Current.
- b) $\Delta L/L0A = 10\%$ Max. at Rated Current.
- c) Operating temp. : -40° C to +125° C
- d) Storage condition (component in its packaging)
 - i) Temperature : -10 to 40° C
 - ii) Humidity : 60%
- e) Resistance to solder heat : 260° C.10 secs



RoHS Compliant

NOTE : Specifications subject to change without notice. Please check our website for latest information.

06.01.2015



SUPERWORLD ELECTRONICS (S) PTE LTD

6. ELECTRICAL CHARACTERISTICS :

Part No.	Inductance (μ H)	Test Frequency (Hz)	RDC (m Ω) Max.	IDC (A) Max.
PSB10031R8MZF	1.8 \pm 20%	1V / 100K	27	4.00
PSB10032R7MZF	2.7 \pm 20%	1V / 100K	30	3.65
PSB10033R9MZF	3.9 \pm 20%	1V / 100K	35	3.15
PSB10034R7MZF	4.7 \pm 20%	1V / 100K	40	3.00
PSB10036R8MZF	6.8 \pm 20%	1V / 100K	50	2.35
PSB1003100MZF	10.0 \pm 20%	1V / 100K	60	2.20
PSB1003120MZF	12.0 \pm 20%	1V / 100K	80	2.00
PSB1003150MZF	15.0 \pm 20%	1V / 100K	100	1.75
PSB1003180LZF	18.0 \pm 15%	1V / 100K	110	1.70
PSB1003220LZF	22.0 \pm 15%	1V / 100K	140	1.60
PSB1003270LZF	27.0 \pm 15%	1V / 100K	160	1.40
PSB1003330LZF	33.0 \pm 15%	1V / 100K	210	1.20
PSB1003390LZF	39.0 \pm 15%	1V / 100K	235	1.10
PSB1003470LZF	47.0 \pm 15%	1V / 100K	280	1.00
PSB1003560LZF	56.0 \pm 15%	1V / 100K	320	0.90
PSB1003680LZF	68.0 \pm 15%	1V / 100K	370	0.85
PSB1003820LZF	82.0 \pm 15%	1V / 100K	430	0.75
PSB1003101KZF	100.0 \pm 10%	1V / 100K	560	0.70
PSB1003121KZF	120.0 \pm 10%	1V / 100K	640	0.60
PSB1003151KZF	150.0 \pm 10%	1V / 100K	730	0.55
PSB1003181KZF	180.0 \pm 10%	1V / 100K	960	0.50
PSB1003221KZF	220.0 \pm 10%	1V / 100K	1100	0.48
PSB1003271KZF	270.0 \pm 10%	1V / 100K	1240	0.45
PSB1003331KZF	330.0 \pm 10%	1V / 100K	1640	0.38
PSB1003391KZF	390.0 \pm 10%	1V / 100K	1790	0.35
PSB1003471KZF	470.0 \pm 10%	1V / 100K	2050	0.30
PSB1003561KZF	560.0 \pm 10%	1V / 100K	2890	0.29
PSB1003681KZF	680.0 \pm 10%	1V / 100K	3240	0.27
PSB1003821KZF	820.0 \pm 10%	1V / 100K	3700	0.25
PSB1003102KZF	1000.0 \pm 10%	1V / 100K	7000	0.24



RoHS Compliant

NOTE : Specifications subject to change without notice. Please check our website for latest information.

06.01.2015



SUPERWORLD ELECTRONICS (S) PTE LTD

7. CHARACTERISTICS CURVES :

@ TEMP. RISE VS. DC SUPERPOSITION RESPONSE CURVE

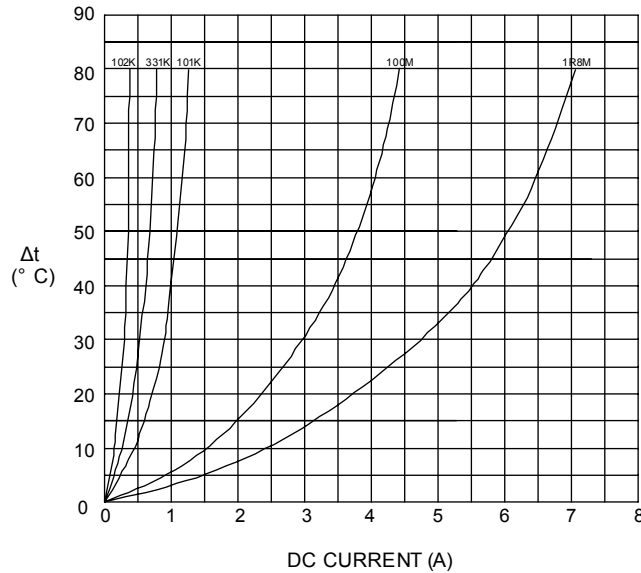

@ INDUCTANCE VS. FREQUENCY RESPONSE CURVE

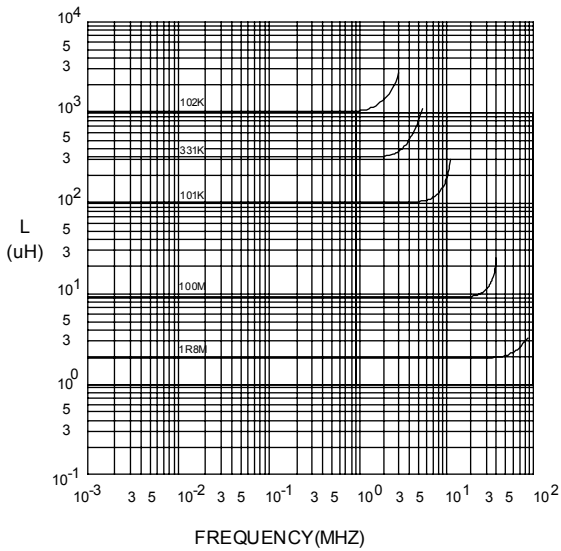

@ INDUCTANCE VS. DC SUPERPOSITION RESPONSE CURVE

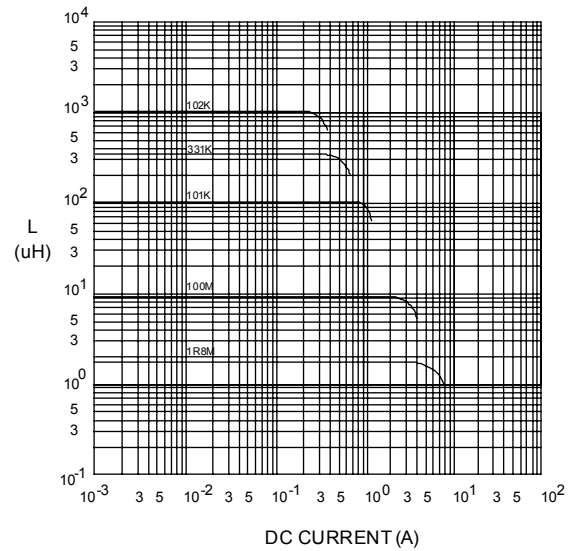

NOTE : Specifications subject to change without notice. Please check our website for latest information.



RoHS Compliant



RECOMMENDED SOLDERING CONDITIONS REFLOW SOLDERINGS

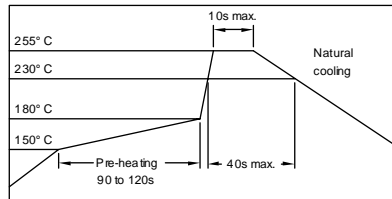

8. PACKAGING INFORMATION :

(1) CONFIGURATION

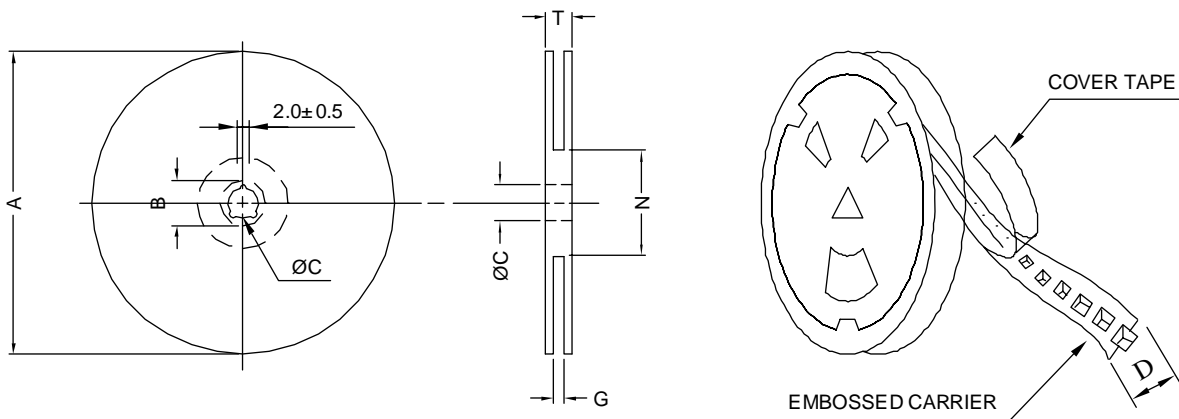

* CARRIER TAPE WIDTH : D

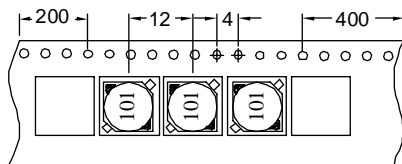

(2) DIMENSIONS

Unit:m/m

STYLE	A	B	C	D	G	N	T
13-24	330	21±0.8	13±0.5	24	26 ⁺⁰	50 ⁻⁰	30.4

(3) QTY & G.W. PER PACKAGE

SERIES	INNER : REEL			OUTER : CARTON		
	QTY (PCS)	G.W. (gw)	STYLE	QTY (PCS)	G.W. (Kg)	SIZE (cm)
PSB1003	1000	900	13-24	4000	7.1	40 x 40 x 24



RoHS Compliant

NOTE : Specifications subject to change without notice. Please check our website for latest information.

06.01.2015



SUPERWORLD ELECTRONICS (S) PTE LTD