

1. PART NO. EXPRESSION :

PSB 1004 101 K Z F
 (a) (b) (c) (d)(e)(f)

(a) Series code

(b) Dimension code

(c) Inductance code : 101 = 100.0uH

(d) Tolerance code : K = ± 10%, L = ± 15%, M = ± 20%

(e) Z : Standard part

(f) F : RoHS Compliant

2. CONFIGURATION & DIMENSIONS :

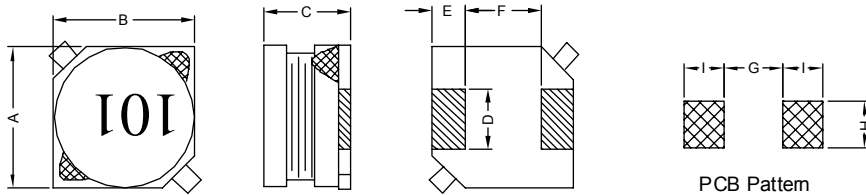

Unit:m/m

A	B	C	D	E	F	G	H	I
10.0±0.3	10.0±0.3	4.6±0.3	2.4±0.2	2.0±0.2	6.0±0.2	5.7 Ref.	2.8 Ref.	2.5 Ref.

3. SCHEMATIC :

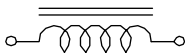

4. MATERIALS :

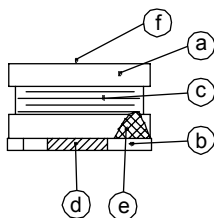

(a) Core

(b) Base

(c) Wire

(d) Terminal

(e) Adhesive

(f) Ink

5. GENERAL SPECIFICATION :

- a) Temp. rise : 40° C Max. at Rated Current.
- b) Rated current : Base on temp. rise & $\Delta L/L0A = 10\%$ Max.
- c) Operating temp. : -40° C to +85° C
- d) Storage condition (component in its packaging)
 - i) Temperature : -10 to 40° C
 - ii) Humidity : 60%
- e) Resistance to solder heat : 260° C.10 secs



RoHS Compliant

NOTE : Specifications subject to change without notice. Please check our website for latest information.

06.01.2015

6. ELECTRICAL CHARACTERISTICS :

Part No.	Inductance (μ H)	Test Frequency (Hz)	RDC (m Ω) Max.	IDC (A) Max.
PSB10041R8MZF	1.8 \pm 20%	1V / 100K	23	5.50
PSB10042R7MZF	2.7 \pm 20%	1V / 100K	25	5.00
PSB10043R9MZF	3.9 \pm 20%	1V / 100K	30	4.50
PSB10044R7MZF	4.7 \pm 20%	1V / 100K	35	4.00
PSB10046R8MZF	6.8 \pm 20%	1V / 100K	40	3.80
PSB1004100MZF	10.0 \pm 20%	1V / 100K	50	3.30
PSB1004120MZF	12.0 \pm 20%	1V / 100K	55	3.20
PSB1004150MZF	15.0 \pm 20%	1V / 100K	65	3.00
PSB1004180LZF	18.0 \pm 15%	1V / 100K	70	2.70
PSB1004220LZF	22.0 \pm 15%	1V / 100K	80	2.60
PSB1004270LZF	27.0 \pm 15%	1V / 100K	90	2.40
PSB1004330LZF	33.0 \pm 15%	1V / 100K	110	2.00
PSB1004390LZF	39.0 \pm 15%	1V / 100K	120	1.90
PSB1004470LZF	47.0 \pm 15%	1V / 100K	130	1.80
PSB1004560LZF	56.0 \pm 15%	1V / 100K	180	1.60
PSB1004680LZF	68.0 \pm 15%	1V / 100K	210	1.40
PSB1004820LZF	82.0 \pm 15%	1V / 100K	240	1.30
PSB1004101KZF	100.0 \pm 10%	1V / 100K	290	1.20
PSB1004121KZF	120.0 \pm 10%	1V / 100K	340	1.10
PSB1004151KZF	150.0 \pm 10%	1V / 100K	470	1.00
PSB1004181KZF	180.0 \pm 10%	1V / 100K	530	0.90
PSB1004221KZF	220.0 \pm 10%	1V / 100K	730	0.80
PSB1004271KZF	270.0 \pm 10%	1V / 100K	830	0.70
PSB1004331KZF	330.0 \pm 10%	1V / 100K	990	0.65
PSB1004391KZF	390.0 \pm 10%	1V / 100K	1100	0.60
PSB1004471KZF	470.0 \pm 10%	1V / 100K	1250	0.55
PSB1004561KZF	560.0 \pm 10%	1V / 100K	1600	0.50
PSB1004681KZF	680.0 \pm 10%	1V / 100K	1800	0.45
PSB1004821KZF	820.0 \pm 10%	1V / 100K	2060	0.40
PSB1004102KZF	1000.0 \pm 10%	1V / 100K	2800	0.38



RoHS Compliant

NOTE : Specifications subject to change without notice. Please check our website for latest information.

06.01.2015



SUPERWORLD ELECTRONICS (S) PTE LTD

7. CHARACTERISTICS CURVES :

@ TEMP. RISE VS. DC SUPERPOSITION RESPONSE CURVE

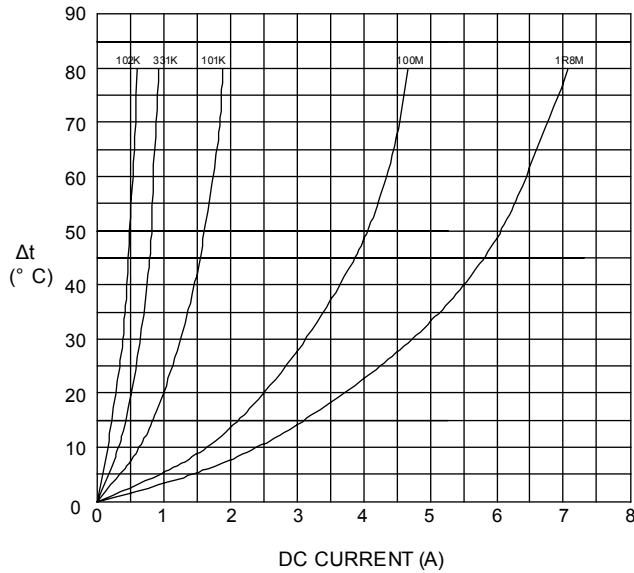

@ INDUCTANCE VS. FREQUENCY RESPONSE CURVE

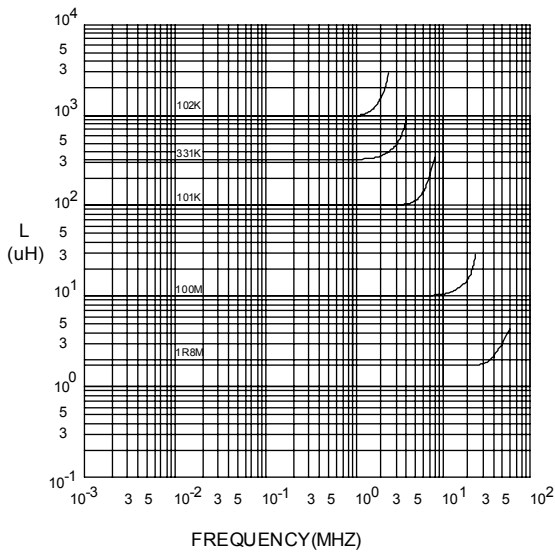

@ INDUCTANCE VS. DC SUPERPOSITION RESPONSE CURVE

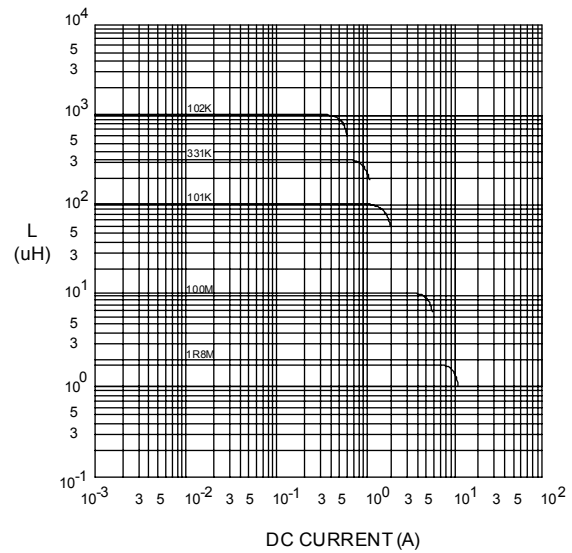

NOTE : Specifications subject to change without notice. Please check our website for latest information.



RoHS Compliant



RECOMMENDED SOLDERING CONDITIONS REFLOW SOLDERINGS

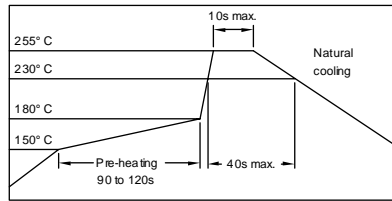

8. PACKAGING INFORMATION :

(1) CONFIGURATION

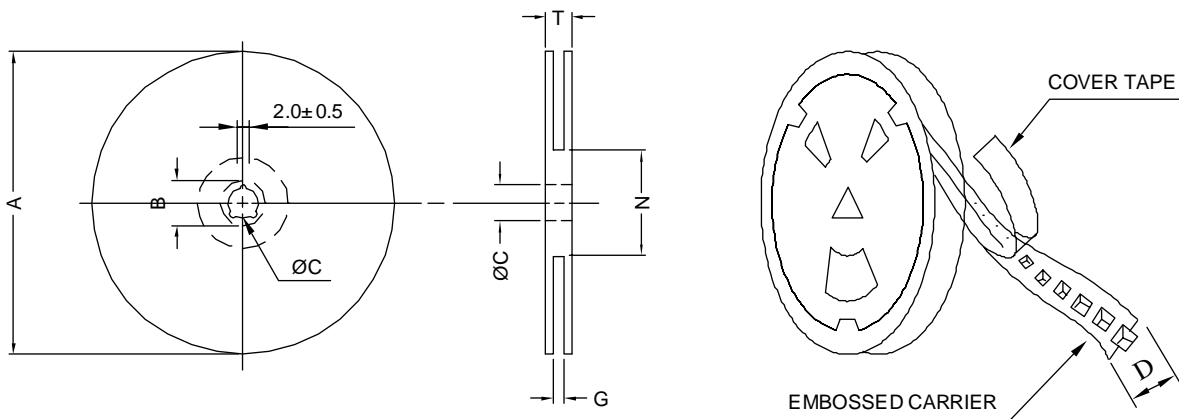

* CARRIER TAPE WIDTH : D

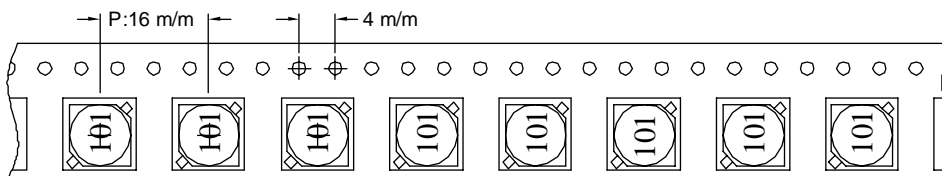

(2) DIMENSIONS

Unit:m/m

STYLE	A	B	C	D	G	N	T
13-24	330	21±0.8	13	24	26 ⁺⁰	50 ⁻⁰	30.4

(3) QTY & G.W. PER PACKAGE

SERIES	INNER : REEL			OUTER : CARTON		
	QTY (PCS)	G.W. (gw)	STYLE	QTY (PCS)	G.W. (Kg)	SIZE (cm)
PSB1004	600	900	13-24	2400	7.1	40 x 40 x 24



RoHS Compliant

NOTE : Specifications subject to change without notice. Please check our website for latest information.

