

# RADIAL CHOKE COIL

RCB0810 SERIES

## 1. PART NO. EXPRESSION :

R C B 0 8 1 0 1 0 0 M Z F  
 (a) (b) (c) (d)(e)(f)

- (a) Series code
- (b) Dimension code
- (c) Inductance code : 100 = 10uH
- (d) Tolerance code : K = ±10%, M = ±20%
- (e) X, Y, Z : Standard part
- (f) F : Lead Free

## 2. CONFIGURATION & DIMENSIONS :

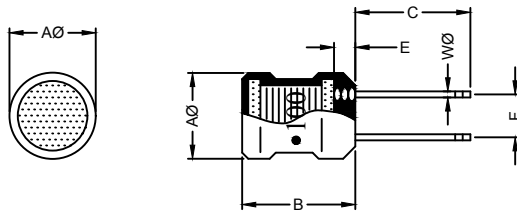

Marking :  
 " ● " : Start

Unit:m/m

AØ	B	C	E	F	WØ
8.7±0.5	10.00±1.0	5.00±1.0	2.50 Max.	5.00±0.8	0.65 Ref.

## 3. SCHEMATIC :

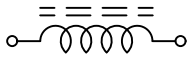

## 4. MATERIALS :

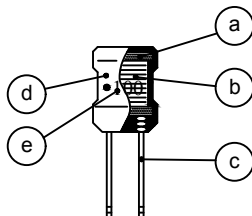

- (a) CORE
- (b) WIRE
- (c) LEAD
- (d) TUBE
- (e) INK

## 5. GENERAL SPECIFICATION :

- a) TEMP. RISE : 20°C MAX. AT RATED CURRENT
- b) THE INDUCTANCE DROP AT RATED CURRENT IS 10% TYP.
- c) STORAGE TEMP. : -40°C TO +125°C
- d) OPERATING TEMP. : -40°C TO +125°C



RoHS Compliant

NOTE : Specifications subject to change without notice. Please check our website for latest information.

15.09.2016



SUPERWORLD ELECTRONICS (S) PTE LTD

### 6. ELECTRICAL CHARACTERISTICS :

Part No.	Inductance ( $\mu$ H )	Test Frequency ( Hz )	Q Ref.	Test Frequency ( Hz )	SRF ( MHz ) Typ.	RDC ( $\Omega$ ) Max.	IDC ( A ) Max.	ISAT ( A ) Max.
RCB08101R5MZF	1.5 $\pm$ 20%	1V/1K	30	1V/7.960M	78.0	0.008	5.40	5.40
RCB08102R2MZF	2.2 $\pm$ 20%	1V/1K	30	1V/7.960M	63.0	0.010	4.50	4.50
RCB08103R3MZF	3.3 $\pm$ 20%	1V/1K	30	1V/7.960M	50.0	0.018	3.60	3.60
RCB08104R7MZF	4.7 $\pm$ 20%	1V/1K	30	1V/7.960M	41.0	0.022	3.10	3.10
RCB08106R8MZF	6.8 $\pm$ 20%	1V/1K	30	1V/7.960M	33.0	0.028	2.50	2.50
RCB0810100KZF	10.0 $\pm$ 10%	1V/1K	60	1V/2.520M	27.0	0.043	2.10	2.10
RCB0810150KZF	15.0 $\pm$ 10%	1V/1K	50	1V/2.520M	21.0	0.056	1.70	1.70
RCB0810220KZF	22.0 $\pm$ 10%	1V/1K	50	1V/2.520M	17.0	0.086	1.40	1.40
RCB0810330KZF	33.0 $\pm$ 10%	1V/1K	45	1V/2.520M	13.0	0.140	1.10	1.10
RCB0810470KZF	47.0 $\pm$ 10%	1V/1K	40	1V/2.520M	11.0	0.170	0.96	0.96
RCB0810680KZF	68.0 $\pm$ 10%	1V/1K	35	1V/2.520M	9.0	0.280	0.79	0.79
RCB0810101KZF	100.0 $\pm$ 10%	1V/1K	55	1V/0.796M	7.2	0.330	0.66	0.66
RCB0810151KZF	150.0 $\pm$ 10%	1V/1K	40	1V/0.796M	5.7	0.560	0.53	0.53
RCB0810221KZF	220.0 $\pm$ 10%	1V/1K	30	1V/0.796M	4.5	0.720	0.44	0.44
RCB0810331KZF	330.0 $\pm$ 10%	1V/1K	25	1V/0.796M	3.6	1.100	0.36	0.36
RCB0810471KZF	470.0 $\pm$ 10%	1V/1K	25	1V/0.796M	2.9	1.700	0.30	0.30
RCB0810681KZF	680.0 $\pm$ 10%	1V/1K	25	1V/0.796M	2.3	2.300	0.25	0.25
RCB0810102KZF	1000.0 $\pm$ 10%	1V/1K	55	1V/0.252M	1.9	4.300	0.20	0.20

### RECOMMENDED SOLDERING CONDITIONS REFLOW SOLDERINGS

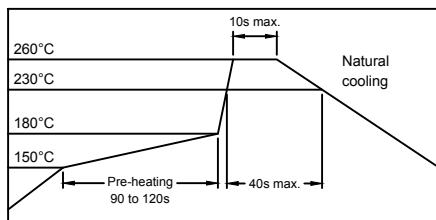

**RoHS Compliant**

NOTE : Specifications subject to change without notice. Please check our website for latest information.

15.09.2016



**SUPERWORLD ELECTRONICS (S) PTE LTD**

### 7. CHARACTERISTICS CURVES :

@ TEMP. RISE VS. DC SUPERPOSITION RESPONSE CURVE

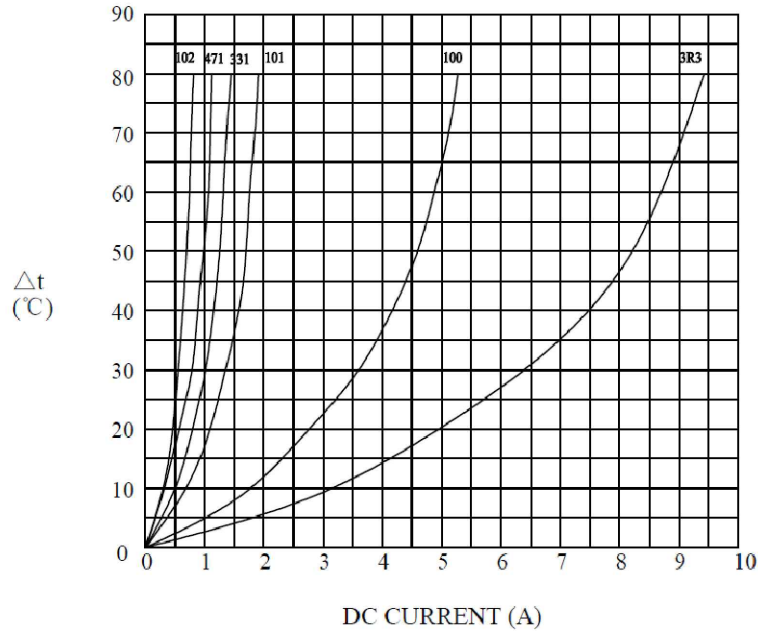

@ INDUCTANCE VS. FREQUENCY RESPONSE CURVE

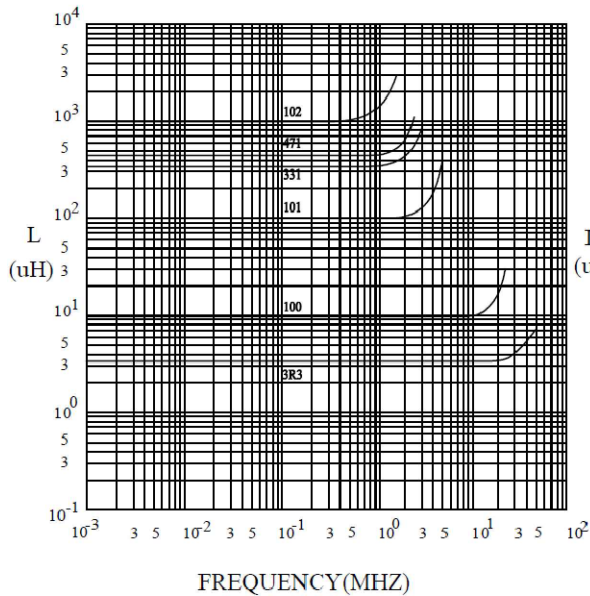

@ INDUCTANCE VS. DC SUPERPOSITION RESPONSE CURVE

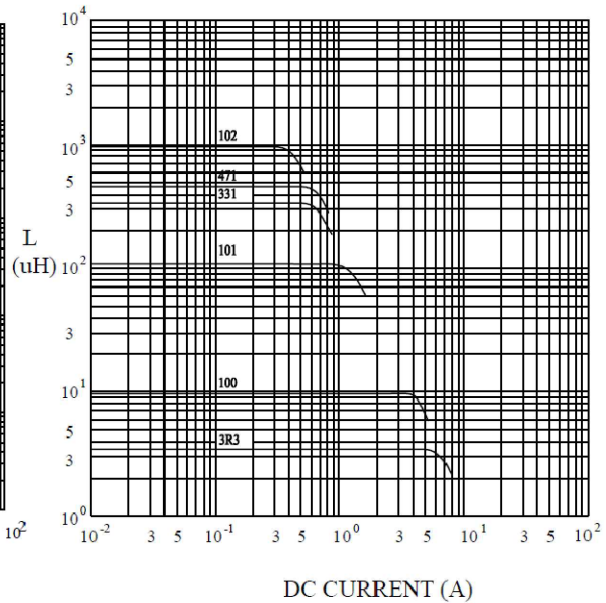

RoHS Compliant

NOTE : Specifications subject to change without notice. Please check our website for latest information.

15.09.2016



SUPERWORLD ELECTRONICS (S) PTE LTD

### 8. PACKAGING INFORMATION :

CODE	INNER PACKAGE	INNER PACKAGE Q'TY
F	TRAY	200 PCS



**RoHS Compliant**

*NOTE : Specifications subject to change without notice. Please check our website for latest information.*

15.09.2016



**SUPERWORLD ELECTRONICS (S) PTE LTD**