

1. PART NO. EXPRESSION :

R C B 1 6 2 0 1 0 0 M Z F
 (a) (b) (c) (d)(e)(f)

- (a) Series code
- (b) Dimension code
- (c) Inductance code : 100 = 10uH
- (d) Tolerance code : K = ±10%, M = ±20%
- (e) X, Y, Z : Standard part
- (f) F : Lead Free

2. CONFIGURATION & DIMENSIONS :

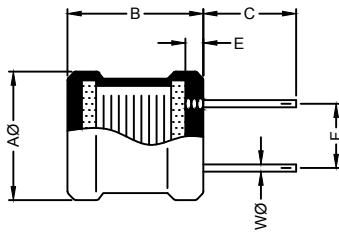

Unit:m/m

AØ	B	C	E	F	WØ
16.0 Max.	20.0 Max.	15.0±5.0	3.0 Max.	8.0±1.5	1.0±0.1

3. SCHEMATIC :

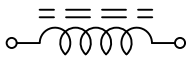

4. MATERIALS :

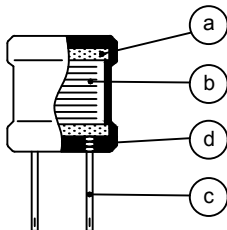

- (a) CORE
- (b) WIRE
- (c) LEAD
- (d) TUBE

5. GENERAL SPECIFICATION :

- a) THE INDUCTANCE DROP AT RATED CURRENT IS 10% MAX.
- b) TEMP. RISE: 45°C MAX. AT RATED CURRENT
- c) STORAGE TEMP. : -40°C TO +125°C
- d) OPERATING TEMP. : -25°C TO +125°C



RoHS Compliant

NOTE : Specifications subject to change without notice. Please check our website for latest information.

15.09.2016



SUPERWORLD ELECTRONICS (S) PTE LTD

6. ELECTRICAL CHARACTERISTICS :

Part No.	Inductance (μH)	Test Frequency (Hz)	RDC (Ω) Max.	IDC (A) Max.
RCB1620100MZF	10 \pm 20%	1V / 1K	0.024	5.0
RCB1620250KZF	25 \pm 10%	1V / 1K	0.040	4.0
RCB1620500KZF	50 \pm 10%	1V / 1K	0.060	3.0
RCB1620101KZF	100 \pm 10%	1V / 1K	0.090	2.0
RCB1620251KZF	250 \pm 10%	1V / 1K	0.180	1.5
RCB1620501KZF	500 \pm 10%	1V / 1K	0.400	1.0
RCB1620102KZF	1000 \pm 10%	1V / 1K	0.800	0.7

RECOMMENDED SOLDERING CONDITIONS REFLOW SOLDERINGS

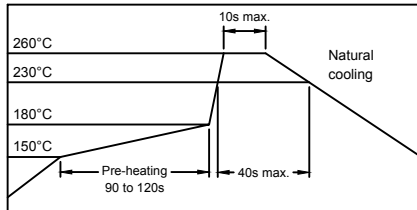

RoHS Compliant

NOTE : Specifications subject to change without notice. Please check our website for latest information.

15.09.2016



SUPERWORLD ELECTRONICS (S) PTE LTD

7. CHARACTERISTICS CURVES :

@ TEMP. RISE VS. DC SUPERPOSITION RESPONSE CURVE

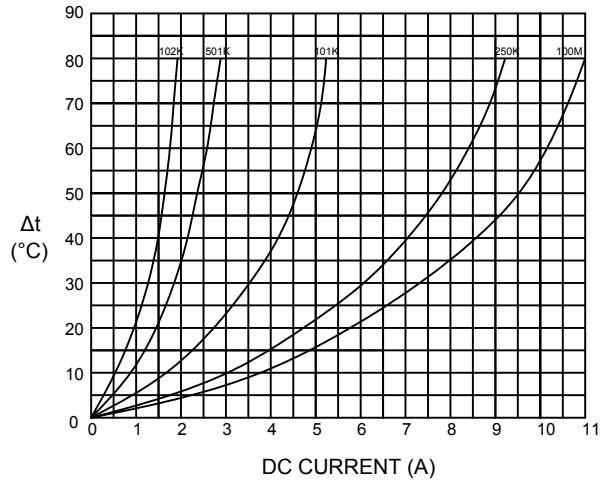

@ INDUCTANCE VS. FREQUENCY RESPONSE CURVE

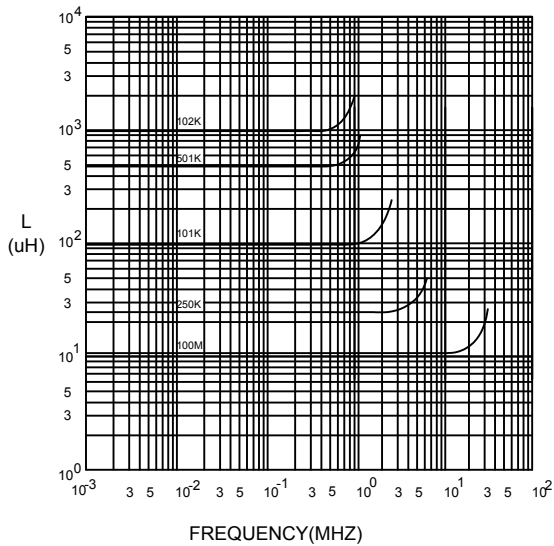

@ INDUCTANCE VS. DC SUPERPOSITION RESPONSE CURVE

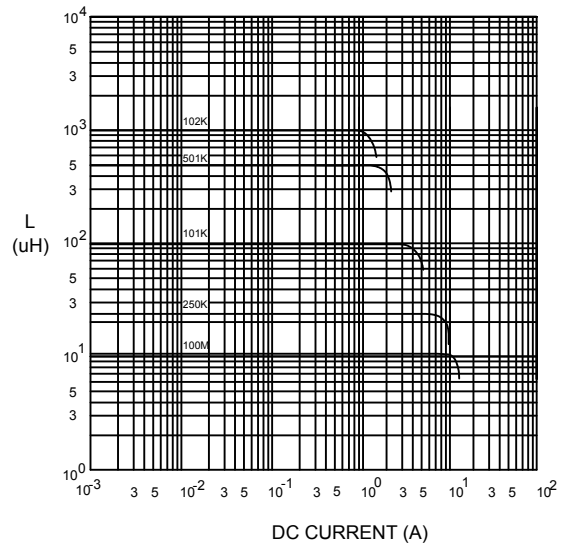

NOTE : Specifications subject to change without notice. Please check our website for latest information.



RoHS Compliant

15.09.2016



SUPERWORLD ELECTRONICS (S) PTE LTD

8. PACKAGING INFORMATION :

CODE	INNER PACKAGE	INNER PACKAGE Q'TY
F	TRAY	100 PCS



RoHS Compliant

NOTE : Specifications subject to change without notice. Please check our website for latest information.

15.09.2016



SUPERWORLD ELECTRONICS (S) PTE LTD