

1. PART NO. EXPRESSION :

SDB0905101MZ F
 (a) (b) (c) (d)(e)(f)

- (a) Series code
- (b) Dimension code
- (c) Inductance code : 101 = 100uH
- (d) Tolerance code : M = ±20%
- (e) Z : Standard part
- (f) F : RoHS Compliant

2. CONFIGURATION & DIMENSIONS :

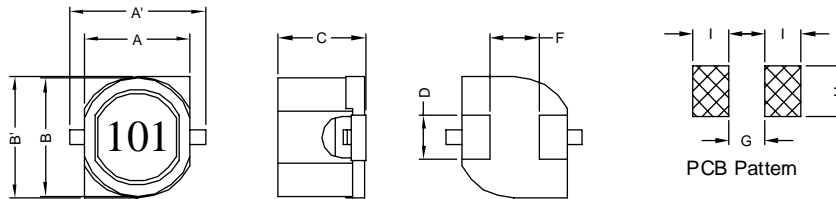

Unit:m/m

| A' | A | B' | B | C | D | F | G | H | I |
|-----------|----------|----------|-----------|---------|---------|---------|----------|----------|----------|
| 12.5 Max. | 9.0 Ref. | 10.1±0.3 | 10.0 Ref. | 5.7±0.3 | 3.0±0.2 | 5.6±0.3 | 4.7 Ref. | 3.9 Ref. | 2.8 Ref. |

3. SCHEMATIC :



4. MATERIALS :

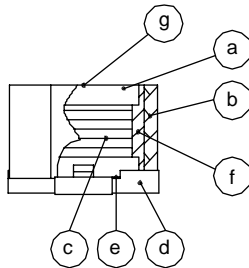

- (a) DR Core
- (b) RI Core
- (c) Wire
- (d) Base
- (e) Adhesive
- (f) Adhesive
- (g) Ink

5. GENERAL SPECIFICATION :

- a) Temp. rise : 50° C Max. at Rated Current.
- b) Rated current : Base on temp. rise L/L0A = 10% Typ.
- c) Operating temp. : -40° C to +75° C
- d) Storage condition (component in its packaging)
 - i) Temperature : -10 to 40° C
 - ii) Humidity : 60%
- e) Resistance to solder heat : 260° C.10 secs



RoHS Compliant

NOTE : Specifications subject to change without notice. Please check our website for latest information.

25.11.2014



SUPERWORLD ELECTRONICS (S) PTE LTD

6. ELECTRICAL CHARACTERISTICS :

| Part No. | Inductance (μ H) | Test Freq. (Hz) | RDC (Ω) Max. | IDC (A) |
|---------------|--------------------------|-------------------|-----------------------------|--------------|
| SDB0905100MZF | 10 \pm 20% | 1V/1K | 0.04 | 2.40 |
| SDB0905120MZF | 12 \pm 20% | 1V/1K | 0.05 | 2.30 |
| SDB0905150MZF | 15 \pm 20% | 1V/1K | 0.06 | 2.10 |
| SDB0905180MZF | 18 \pm 20% | 1V/1K | 0.06 | 1.90 |
| SDB0905220MZF | 22 \pm 20% | 1V/1K | 0.07 | 1.70 |
| SDB0905270MZF | 27 \pm 20% | 1V/1K | 0.08 | 1.60 |
| SDB0905330MZF | 33 \pm 20% | 1V/1K | 0.10 | 1.40 |
| SDB0905390MZF | 39 \pm 20% | 1V/1K | 0.15 | 1.30 |
| SDB0905470MZF | 47 \pm 20% | 1V/1K | 0.15 | 1.20 |
| SDB0905560MZF | 56 \pm 20% | 1V/1K | 0.20 | 1.10 |
| SDB0905680MZF | 68 \pm 20% | 1V/1K | 0.25 | 0.97 |
| SDB0905820MZF | 82 \pm 20% | 1V/1K | 0.25 | 0.88 |
| SDB0905101MZF | 100 \pm 20% | 1V/1K | 0.30 | 0.80 |
| SDB0905121MZF | 120 \pm 20% | 1V/1K | 0.35 | 0.73 |
| SDB0905151MZF | 150 \pm 20% | 1V/1K | 0.40 | 0.65 |
| SDB0905181MZF | 180 \pm 20% | 1V/1K | 0.55 | 0.60 |
| SDB0905221MZF | 220 \pm 20% | 1V/1K | 0.60 | 0.54 |
| SDB0905271MZF | 270 \pm 20% | 1V/1K | 0.80 | 0.49 |
| SDB0905331MZF | 330 \pm 20% | 1V/1K | 0.90 | 0.44 |
| SDB0905391MZF | 390 \pm 20% | 1V/1K | 1.00 | 0.41 |
| SDB0905471MZF | 470 \pm 20% | 1V/1K | 1.30 | 0.37 |



RoHS Compliant

NOTE : Specifications subject to change without notice. Please check our website for latest information.

25.11.2014



SUPERWORLD ELECTRONICS (S) PTE LTD

PG. 2

6. ELECTRICAL CHARACTERISTICS :

@ TEMP. RISE VS. DC SUPERPOSITION RESPONSE CURVE

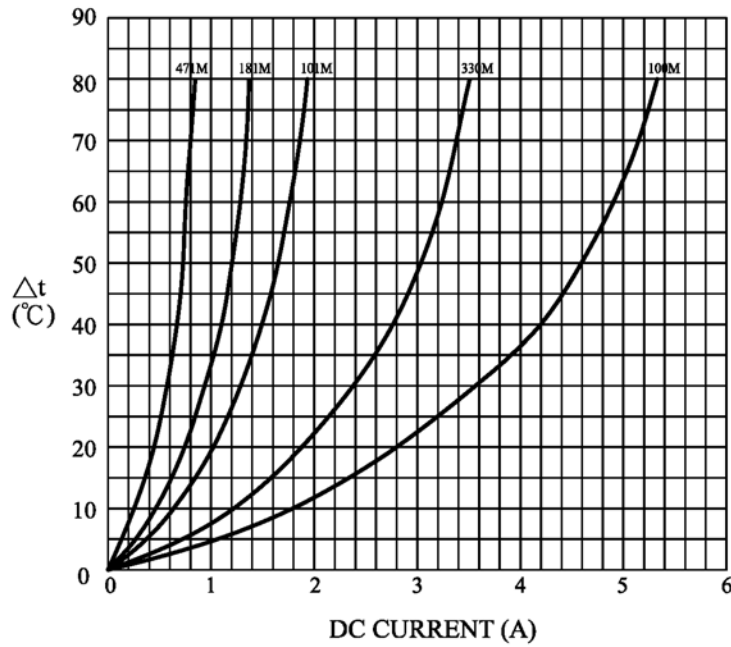

@ INDUCTANCE VS. FREQUENCY RESPONSE CURVE

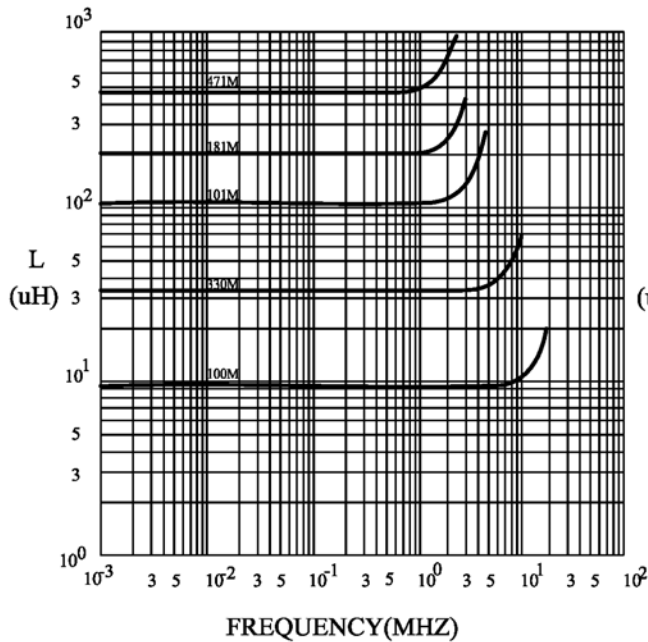

@ INDUCTANCE VS. DC SUPERPOSITION RESPONSE CURVE

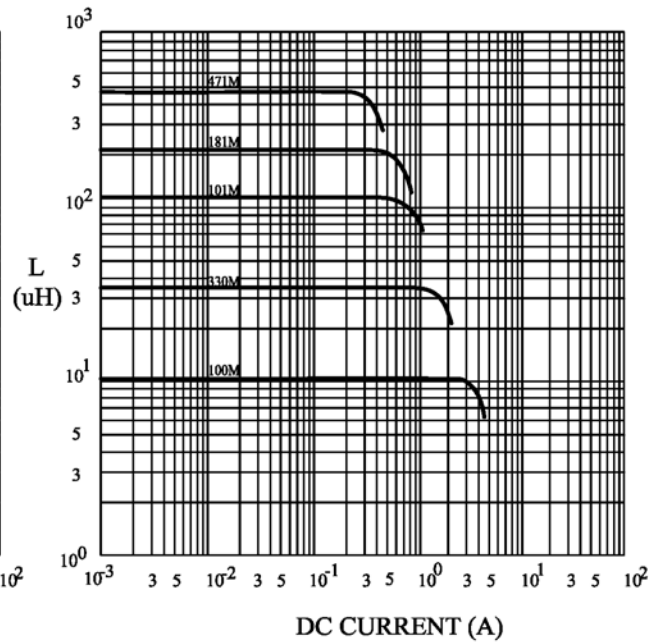

NOTE : Specifications subject to change without notice. Please check our website for latest information.



RoHS Compliant



RECOMMENDED SOLDERING CONDITIONS REFLOW SOLDERINGS

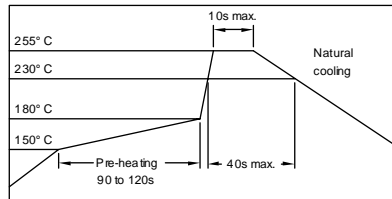

7. PACKAGING INFORMATION :

(1) CONFIGURATION

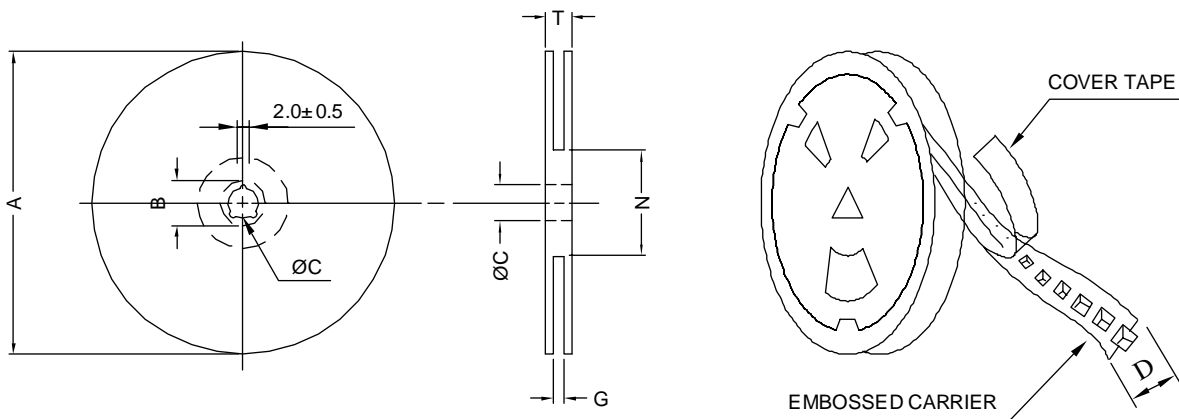

* CARRIER TAPE WIDTH : D

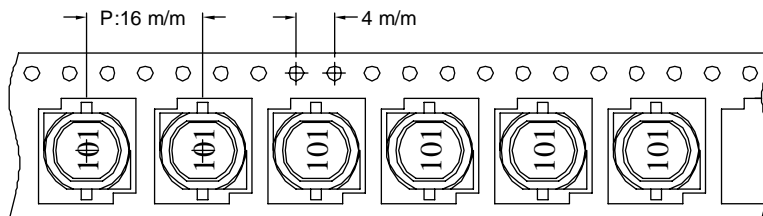

(2) DIMENSIONS

Unit:m/m

| STYLE | A | B | C | D | G | N | T |
|-------|-----|--------|----|----|------------------|------------------|------|
| 13-24 | 330 | 21±0.8 | 13 | 24 | 26 ⁺⁰ | 50 ⁻⁰ | 30.4 |

(3) QTY & G.W. PER PACKAGE

| SERIES | INNER : REEL | | | OUTER : CARTON | | |
|---------|--------------|-----------|-------|----------------|-----------|--------------|
| | QTY (PCS) | G.W. (gw) | STYLE | QTY (PCS) | G.W. (Kg) | SIZE (cm) |
| SDB0905 | 500 | 1200 | 13-24 | 2000 | 8.3 | 40 x 40 x 24 |



RoHS Compliant

NOTE : Specifications subject to change without notice. Please check our website for latest information.

25.11.2014



SUPERWORLD ELECTRONICS (S) PTE LTD