

1. PART NO. EXPRESSION :

SDB 1507 101 MZF
 (a) (b) (c) (d)(e)(f)

- (a) Series code
- (b) Dimension code
- (c) Inductance code : 101 = 100uH
- (d) Tolerance code : M = ±20%
- (e) Z : Standard part
- (f) F : RoHS Compliant

2. CONFIGURATION & DIMENSIONS :

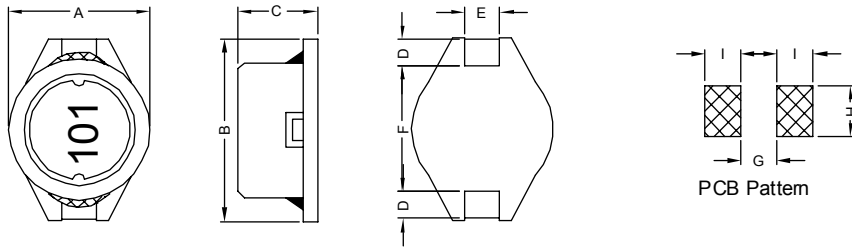

Unit: m/m

A	B	C	D	E	F	G	H	I
15.0± 0.30	18.4± 0.30	7.00± 0.50	2.40± 0.20	2.20± 0.20	13.30± 0.30	12.70 Ref.	2.80 Ref.	3.00 Ref.

3. SCHEMATIC :

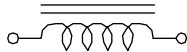

4. MATERIALS :

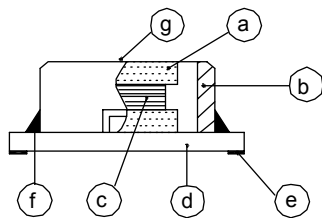

- (a) DR Core
- (b) RI Core
- (c) Wire
- (d) Base
- (e) Terminal
- (f) Adhesive
- (g) Ink

5. GENERAL SPECIFICATION :

- a) Temp. rise : 40° C Typ.
- b) Rated current : Base on temp. rise & ΔL/L0A = 10% Max.
- c) Operating temp. : -40° C to +85° C
- d) Storage condition (component in its packaging)
 - i) Temperature : -10 to 40° C
 - ii) Humidity : 60%
- e) Resistance to solder heat : 260° C.10 secs



RoHS Compliant

NOTE : Specifications subject to change without notice. Please check our website for latest information.

25.11.2014

6. ELECTRICAL CHARACTERISTICS :

Part No.	Inductance (μ H)	Q Ref.	Test Freq. (Hz)	SRF (MHz) Typ.	RDC (m Ω) Max.	IDC (A)
SDB1507100MZF	10.0 \pm 20%	70	1V/100K	20.0	30	4.00
SDB1507150MZF	15.0 \pm 20%	55	1V/100K	17.0	35	3.60
SDB1507220MZF	22.0 \pm 20%	45	1V/100K	15.0	45	3.15
SDB1507330MZF	33.0 \pm 20%	55	1V/100K	10.0	60	2.80
SDB1507470MZF	47.0 \pm 20%	45	1V/100K	8.5	80	2.45
SDB1507680MZF	68.0 \pm 20%	50	1V/100K	6.5	115	2.00
SDB1507101MZF	100.0 \pm 20%	70	1V/100K	5.5	180	1.70
SDB1507151MZF	150.0 \pm 20%	60	1V/100K	5.0	220	1.35
SDB1507221MZF	220.0 \pm 20%	65	1V/100K	4.0	320	1.15
SDB1507331MZF	330.0 \pm 20%	80	1V/100K	3.0	500	0.90
SDB1507471MZF	470.0 \pm 20%	90	1V/100K	2.5	750	0.75
SDB1507681MZF	680.0 \pm 20%	100	1V/100K	2.3	1100	0.65
SDB1507102MZF	1000.0 \pm 20%	90	1V/100K	1.9	1500	0.55



RoHS Compliant

NOTE : Specifications subject to change without notice. Please check our website for latest information.

25.11.2014



SUPERWORLD ELECTRONICS (S) PTE LTD

PG. 2

6. ELECTRICAL CHARACTERISTICS :

@ TEMP. RISE VS. DC SUPERPOSITION RESPONSE CURVE

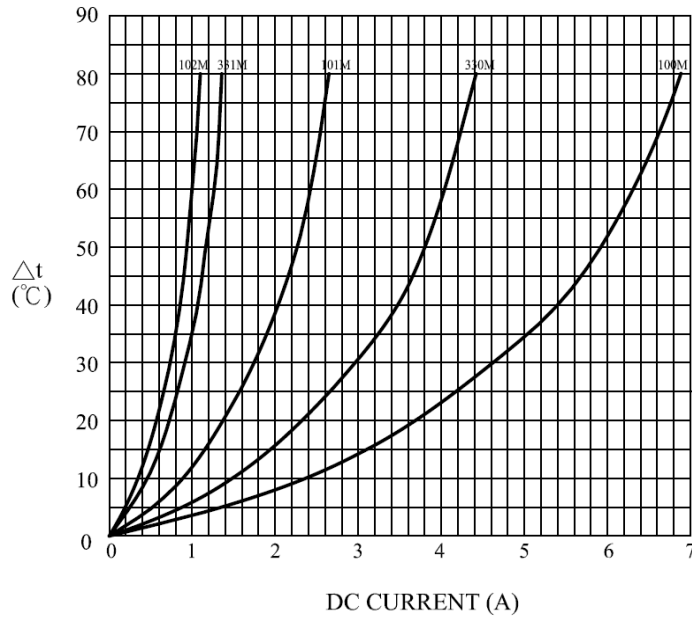

@ INDUCTANCE VS. FREQUENCY RESPONSE CURVE

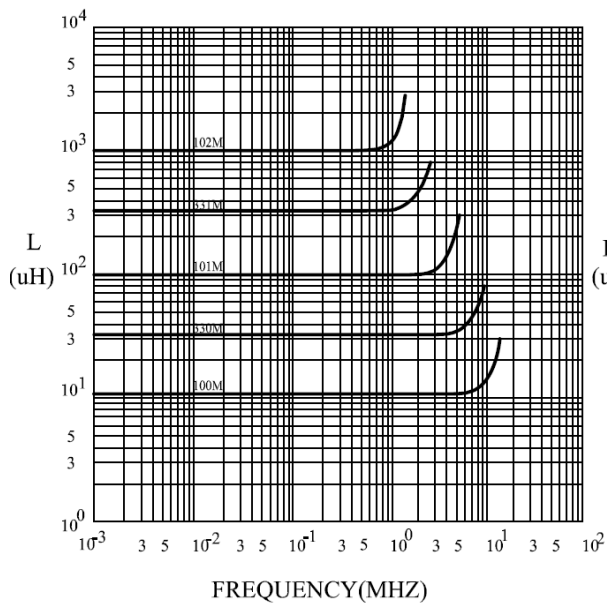

@ INDUCTANCE VS. DC SUPERPOSITION RESPONSE CURVE

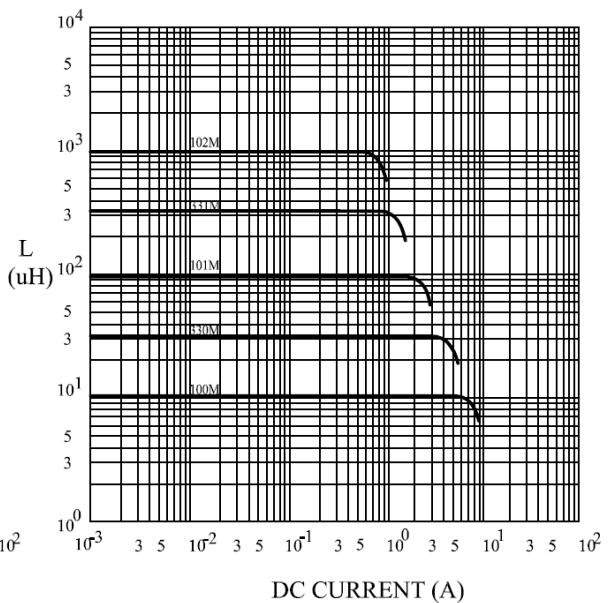

NOTE : Specifications subject to change without notice. Please check our website for latest information.



RoHS Compliant

25.11.2014



SUPERWORLD ELECTRONICS (S) PTE LTD

RECOMMENDED SOLDERING CONDITIONS REFLOW SOLDERINGS

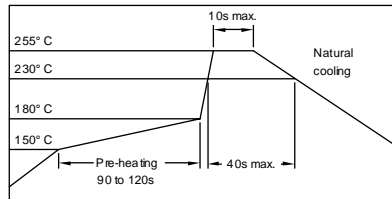

7. PACKAGING INFORMATION :

(1) CONFIGURATION

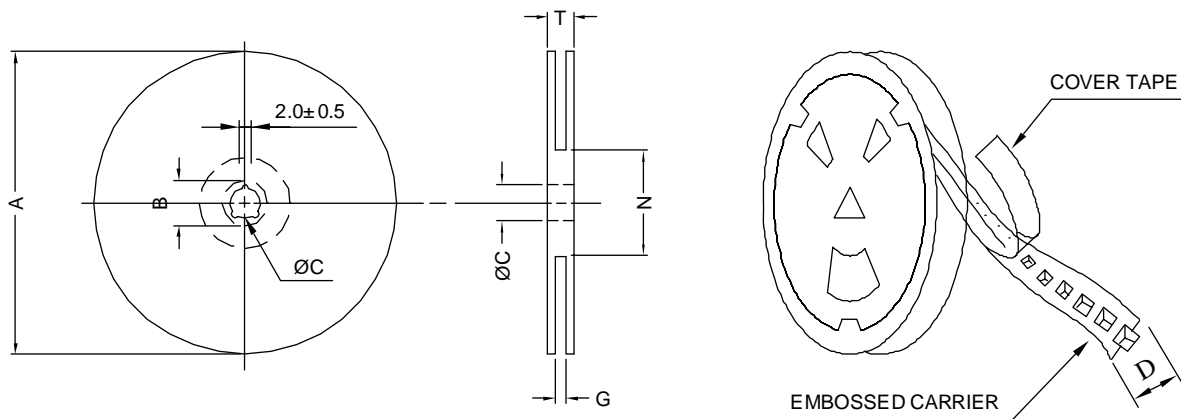

* CARRIER TAPE WIDTH : D

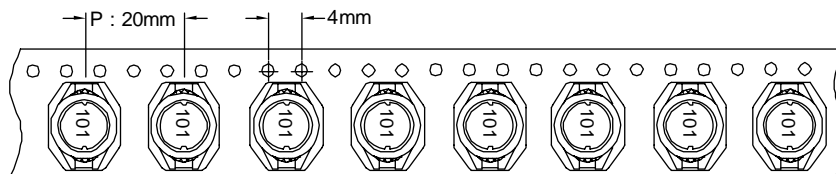

(2) DIMENSIONS

Unit:m/m

STYLE	A	B	C	D	G	N	T
13-32	330	21±0.8	13±0.5	32	34 ⁺⁰	100 ⁻⁰	38.4

(3) QTY & G.W. PER PACKAGE

SERIES	INNER : REEL			OUTER : CARTON		
	QTY (PCS)	G.W. (gw)	STYLE	QTY (PCS)	G.W. (Kg)	SIZE (cm)
SDB1507	350	1750	13-32	1400	10.5	40 x 40 x 26



RoHS Compliant

NOTE : Specifications subject to change without notice. Please check our website for latest information.

25.11.2014