

1. PART NO. EXPRESSION :

SSC 0301 1R5 YZF
 (a) (b) (c) (d)(e)(f)

- (a) Series code
- (b) Dimension code
- (c) Inductance code : 1R5 = 1.5uH
- (d) Tolerance code : Y = ±30%
- (e) Z : Standard part
- (f) F : RoHS Compliant

2. CONFIGURATION & DIMENSIONS :

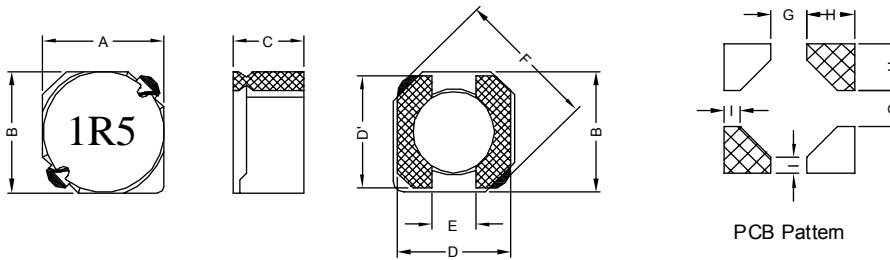

Unit : m/m

A	B	C	D	D'	E	F	G	H	I
4.10 Max.	4.10 Max.	1.80 Max.	3.70 Ref.	3.75 Ref.	1.20 Ref.	5.20 Max.	1.20 Ref.	1.60 Ref.	0.55 Ref.

3. SCHEMATIC :

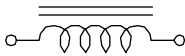

4. MATERIALS :

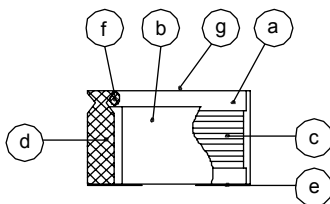

- (a) DR Core
- (b) RI Core
- (c) Wire
- (d) Terminal
- (e) Adhesive
- (f) Adhesive
- (g) Ink

5. GENERAL SPECIFICATION :

- a) Temp. rise : 40° C Max. at Rated Current
- b) $\Delta L/L0A$: 35% Max. at Rated Current
- c) Operating temp. : -40° C to +125° C
- d) Storage condition (component in its packaging)
 - i) Temperature : -10 to 40° C
 - ii) Humidity : 60%
- e) Resistance to solder heat : 260° C.10 secs



RoHS Compliant

NOTE : Specifications subject to change without notice. Please check our website for latest information.

29.12.2014



SUPERWORLD ELECTRONICS (S) PTE LTD

6. ELECTRICAL CHARACTERISTICS :

Part No.	Inductance (μ H)	Test Frequency (Hz)	RDC (m Ω) Max.	IDC (A) Max.
SSC03011R5YZF	1.5 \pm 30%	0.1V / 100 K	52	1.55
SSC03012R2YZF	2.2 \pm 30%	0.1V / 100 K	72	1.20
SSC03013R3YZF	3.3 \pm 30%	0.1V / 100 K	85	1.10
SSC03014R7YZF	4.7 \pm 30%	0.1V / 100 K	105	0.90
SSC03016R8YZF	6.8 \pm 30%	0.1V / 100 K	170	0.73
SSC0301100YZF	10.0 \pm 30%	0.1V / 100 K	210	0.55
SSC0301150YZF	15.0 \pm 30%	0.1V / 100 K	295	0.45
SSC0301220YZF	22.0 \pm 30%	0.1V / 100 K	430	0.40
SSC0301330YZF	33.0 \pm 30%	0.1V / 100 K	675	0.32

**RoHS Compliant**

NOTE : Specifications subject to change without notice. Please check our website for latest information.

29.12.2014

**SUPERWORLD ELECTRONICS (S) PTE LTD**

PG. 2

7. CHARACTERISTICS CURVES :

@ TEMP. RISE VS. DC SUPERPOSITION RESPONSE CURVE

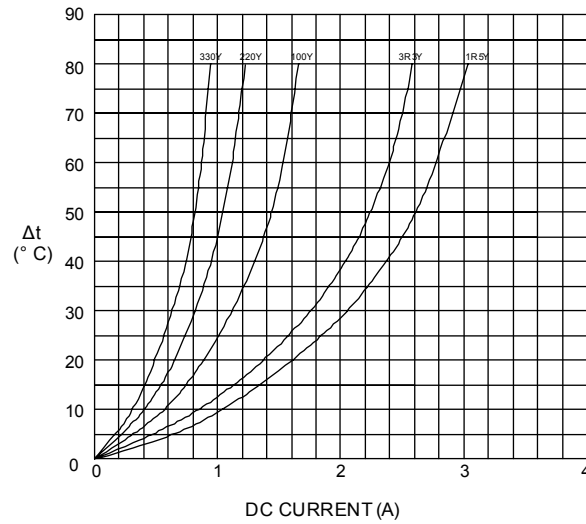

@ INDUCTANCE VS. FREQUENCY RESPONSE CURVE

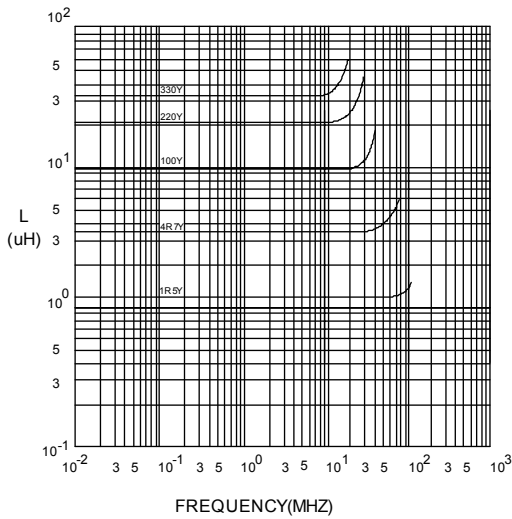

@ INDUCTANCE VS. DC SUPERPOSITION RESPONSE CURVE

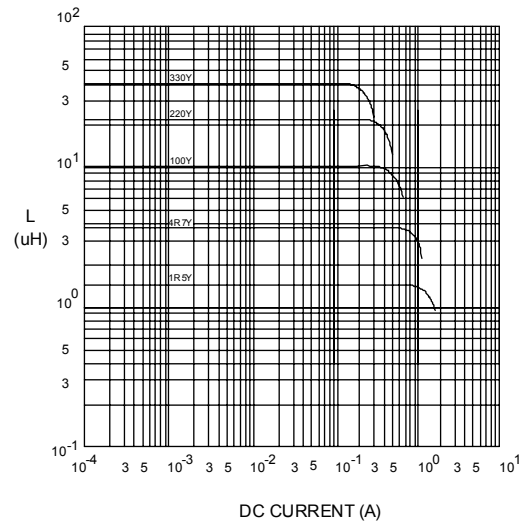

NOTE : Specifications subject to change without notice. Please check our website for latest information.



RoHS Compliant

29.12.2014



SUPERWORLD ELECTRONICS (S) PTE LTD

8. PACKAGING INFORMATION :

(1) CONFIGURATION

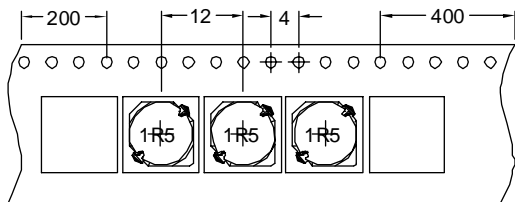
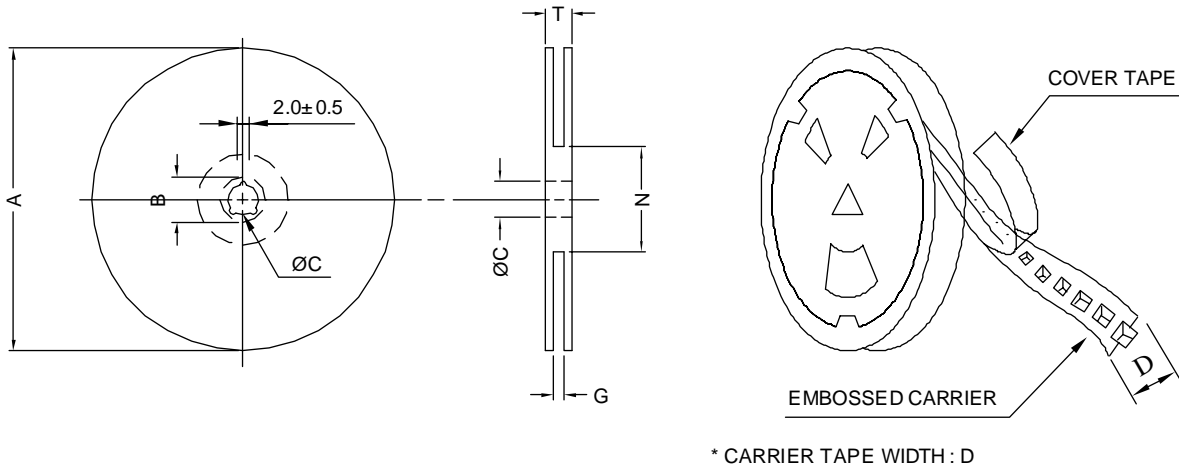

FIG : 1

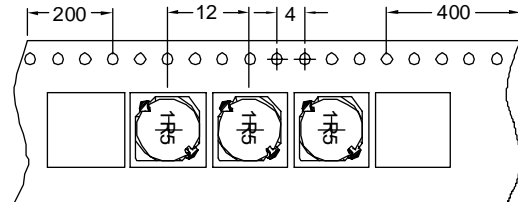

FIG : 2

(2) DIMENSIONS

Unit:m/m

STYLE	A	B	C	D	G	N	T
13-16	330	21±0.8	13±0.5	16	18 ⁺⁰	50 ⁻⁰	22.4

(3) QTY & G.W. PER PACKAGE

SERIES	INNER : REEL			OUTER : CARTON			PACKAGE CODE	FIG
	QTY (PCS)	G.W. (gw)	STYLE	QTY (PCS)	G.W. (Kg)	SIZE (cm)		
SSC0301	3000	2100	13-16	1800	16.1	38 x 36.5 x 21	F	1
SSC0301	3000	2100	13-24	1800	16.1	38 x 36.5 x 21	G	2



RoHS Compliant

NOTE : Specifications subject to change without notice. Please check our website for latest information.

29.12.2014



SUPERWORLD ELECTRONICS (S) PTE LTD