

### 1. PART NO. EXPRESSION :

SSC 0402 1R0 YZF  
 (a) (b) (c) (d)(e)(f)

- (a) Series code
- (b) Dimension code
- (c) Inductance code : 1R0 = 1.0uH
- (d) Tolerance code : Y = ± 30%
- (e) Z : Standard part
- (f) F : RoHS Compliant

### 2. CONFIGURATION & DIMENSIONS :

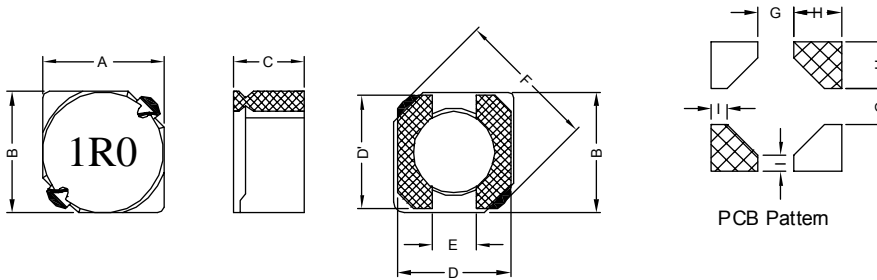

Unit : m/m

| A        | B        | C         | D         | D'        | E         | F         | G         | H         | I         |
|----------|----------|-----------|-----------|-----------|-----------|-----------|-----------|-----------|-----------|
| 4.70±0.3 | 4.70±0.3 | 2.00 Max. | 4.50 Ref. | 4.50 Ref. | 1.50 Ref. | 6.90 Max. | 1.70 Ref. | 1.80 Ref. | 0.80 Ref. |

### 3. SCHEMATIC :

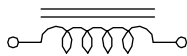

### 4. MATERIALS :

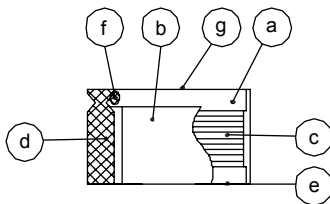

- (a) DR Core
- (b) RI Core
- (c) Wire
- (d) Terminal
- (e) Adhesive
- (f) Adhesive
- (g) Ink

### 5. GENERAL SPECIFICATION :

- a) Temp. rise : 40° C Max. at Rated Current
- b) ΔL/L0A : 35% Max. at Rated Current
- c) Operating temp. : -40° C to +125° C
- d) Storage condition (component in its packaging)
  - i) Temperature : -10 to 40° C
  - ii) Humidity : 60%
- e) Resistance to solder heat : 260° C.10 secs



**RoHS Compliant**

NOTE : Specifications subject to change without notice. Please check our website for latest information.



## 6. ELECTRICAL CHARACTERISTICS :

| Part No.      | Inductance<br>( $\mu$ H) | Test<br>Frequency<br>( Hz ) | RDC<br>( m $\Omega$ )<br>Max. | IDC<br>( A )<br>Max. |
|---------------|--------------------------|-----------------------------|-------------------------------|----------------------|
| SSC04021R0YZF | 1.0 $\pm$ 30%            | 0.5V / 7.96 M               | 45                            | 1.72                 |
| SSC04022R2YZF | 2.2 $\pm$ 30%            | 0.5V / 7.96 M               | 75                            | 1.32                 |
| SSC04022R7YZF | 2.7 $\pm$ 30%            | 0.5V / 7.96 M               | 105                           | 1.28                 |
| SSC04023R3YZF | 3.3 $\pm$ 30%            | 0.5V / 7.96 M               | 110                           | 1.04                 |
| SSC04023R9YZF | 3.9 $\pm$ 30%            | 0.5V / 7.96 M               | 155                           | 0.88                 |
| SSC04024R7YZF | 4.7 $\pm$ 30%            | 0.5V / 7.96 M               | 162                           | 0.84                 |
| SSC04025R6YZF | 5.6 $\pm$ 30%            | 0.5V / 7.96 M               | 170                           | 0.80                 |
| SSC04026R8YZF | 6.8 $\pm$ 30%            | 0.5V / 7.96 M               | 180                           | 0.76                 |
| SSC04028R2YZF | 8.2 $\pm$ 30%            | 0.5V / 7.96 M               | 190                           | 0.68                 |
| SSC0402100YZF | 10.0 $\pm$ 30%           | 0.5V / 100 K                | 200                           | 0.61                 |
| SSC0402100MZF | 10.0 $\pm$ 20%           | 0.5V / 100 K                | 200                           | 0.61                 |
| SSC0402120YZF | 12.0 $\pm$ 30%           | 0.5V / 100 K                | 210                           | 0.56                 |
| SSC0402150YZF | 15.0 $\pm$ 30%           | 0.5V / 100 K                | 240                           | 0.50                 |
| SSC0402180YZF | 18.0 $\pm$ 30%           | 0.5V / 100 K                | 338                           | 0.48                 |
| SSC0402220YZF | 22.0 $\pm$ 30%           | 0.5V / 100 K                | 397                           | 0.41                 |
| SSC0402270YZF | 27.0 $\pm$ 30%           | 0.5V / 100 K                | 441                           | 0.35                 |
| SSC0402330YZF | 33.0 $\pm$ 30%           | 0.5V / 100 K                | 694                           | 0.32                 |
| SSC0402390YZF | 39.0 $\pm$ 30%           | 0.5V / 100 K                | 709                           | 0.30                 |



RoHS Compliant

NOTE : Specifications subject to change without notice. Please check our website for latest information.

29.12.2014



SUPERWORLD ELECTRONICS (S) PTE LTD

## 7. CHARACTERISTICS CURVES :

@ TEMP. RISE VS. DC SUPERPOSITION RESPONSE CURVE

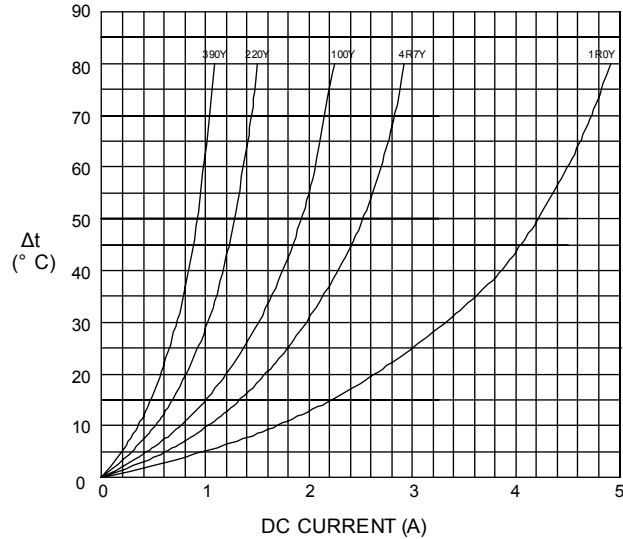

@ INDUCTANCE VS. FREQUENCY RESPONSE CURVE

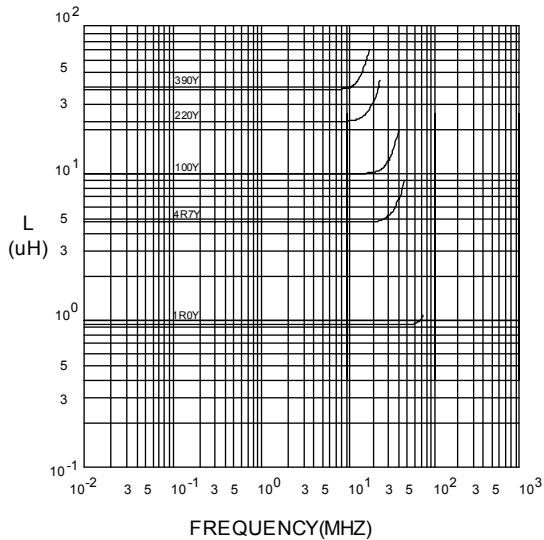

@ INDUCTANCE VS. DC SUPERPOSITION RESPONSE CURVE

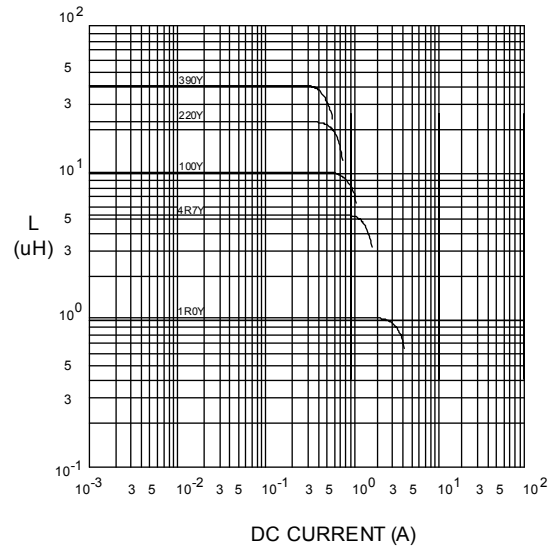

NOTE : Specifications subject to change without notice. Please check our website for latest information.



RoHS Compliant

29.12.2014



SUPERWORLD ELECTRONICS (S) PTE LTD

## 8. PACKAGING INFORMATION :

### ( 1 ) CONFIGURATION

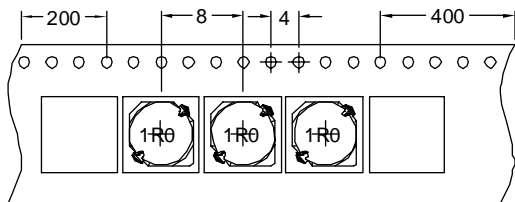
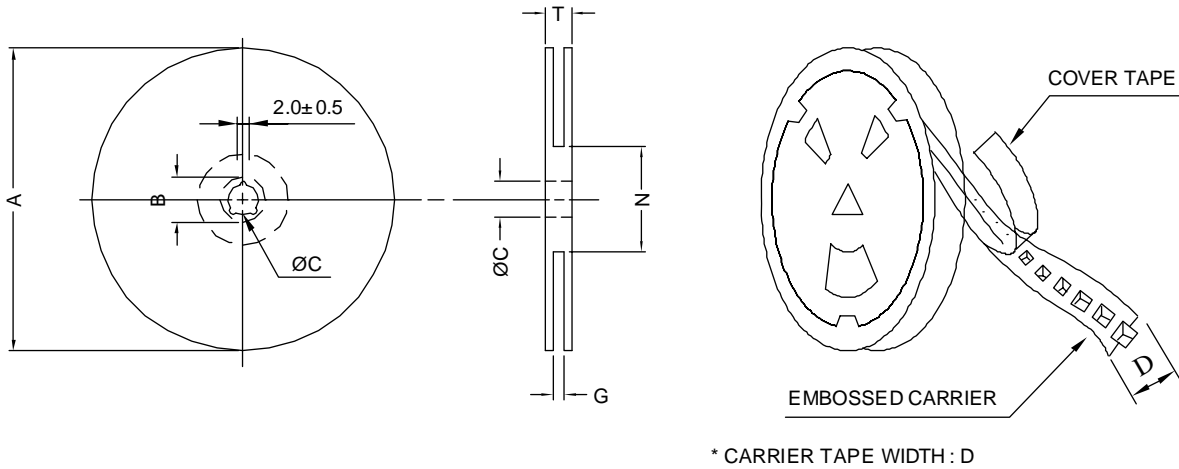

FIG : 1

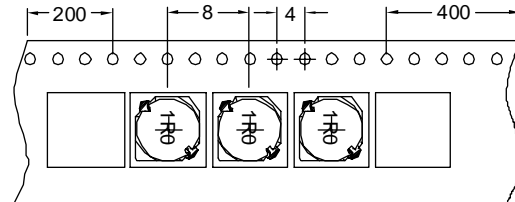

FIG : 2

### ( 2 ) DIMENSIONS

Unit:m/m

| STYLE | A   | B      | C      | D  | G                | N                | T    |
|-------|-----|--------|--------|----|------------------|------------------|------|
| 13-16 | 330 | 21±0.8 | 13±0.5 | 16 | 18 <sup>+0</sup> | 50 <sup>-0</sup> | 22.4 |

### ( 3 ) QTY & G.W. PER PACKAGE

| SERIES  | INNER : REEL |           |       | OUTER : CARTON |           |                | PACKAGE CODE | FIG |
|---------|--------------|-----------|-------|----------------|-----------|----------------|--------------|-----|
|         | QTY (PCS)    | G.W. (gw) | STYLE | QTY (PCS)      | G.W. (Kg) | SIZE (cm)      |              |     |
| SSC0402 | 3000         | 2550      | 13-16 | 18000          | 18.8      | 38 x 36.5 x 21 | F            | 1   |
| SSC0402 | 3000         | 2550      | 13-16 | 18000          | 18.8      | 38 x 36.5 x 21 | G            | 2   |



**RoHS Compliant**

NOTE : Specifications subject to change without notice. Please check our website for latest information.

29.12.2014



**SUPERWORLD ELECTRONICS (S) PTE LTD**