

1. Part No. Expression

P D B 1 0 0 3 1 0 0 M Z F

(a) (b) (c) (d) (e) (f)

- (a) Series Code
- (b) Dimension Code
- (c) Inductance Code
- (d) Tolerance Code
- (e) Special Code
- (f) Packaging Code

2. Configuration & Dimensions (Unit: mm)

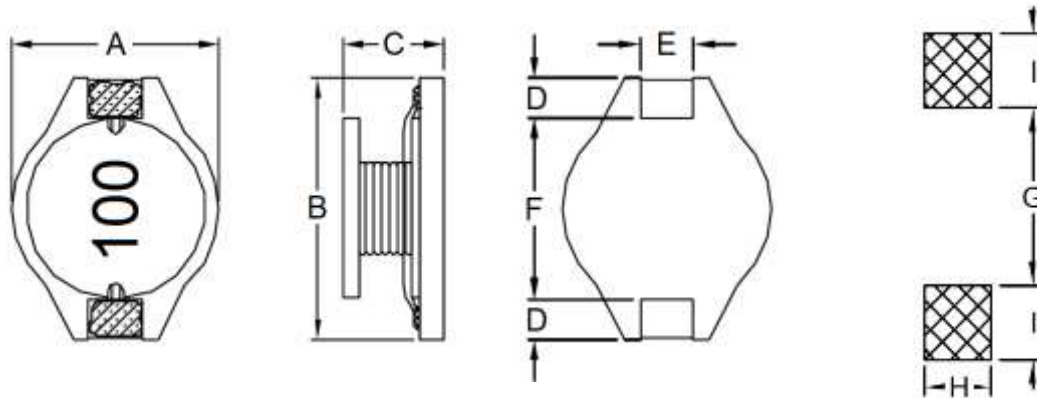

Recommended PCB Layout

- Note: 1. The above PCB layout reference only.
2. Marking: Inductance Code

| A | B | C | D | E |
|----------|----------|---------|---------|---------|
| 10.0±0.2 | 12.7±0.2 | 3.0±0.3 | 2.4±0.2 | 2.2±0.2 |
| F | G | H | I | - |
| 7.6±0.3 | 7.3 Ref | 2.8 Ref | 3.0 Ref | - |

NOTE: Specifications subject to change without notice. Please check our website for latest information.

3. Schematic

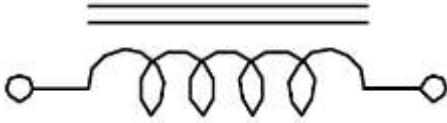

4. Material List

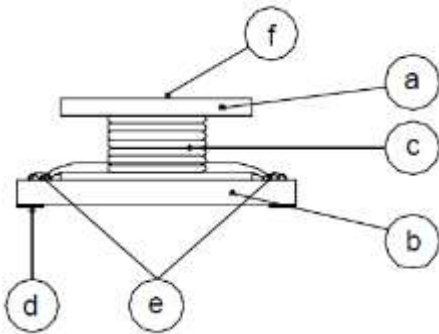

- (a) Core
- (b) Base
- (c) Wire
- (d) Terminal
- (e) Adhesive
- (f) Ink

5. General Specifications

- (a) Operating Temp.: -40°C to +125°C (including self-temperature rise)
- (b) All test data referenced to 25°C ambient.
- (c) Heat Rated Current (I_{rms}) will cause the coil temperature rise ΔT of 30°C Max.
- (d) Saturation Current (I_{sat}) will cause inductance L₀ to drop 10% Max.
- (e) Rated Current: The lower value of I_{sat} and I_{rms}.
- (f) Resistance to solder heat: 260° C.10 secs
- (g) Storage Condition (Component in its packaging)
 - i) Temperature: -10°C to 40°C
 - ii) Humidity: Less than 60% RH

NOTE: Specifications subject to change without notice. Please check our website for latest information.

6. Electrical Characteristics

| Part Number | Inductance (uH) @0A ±20% | Test Frequency | SRF (MHz) Typ | DCR (mΩ) Max | IDC (A) |
|---------------|-----------------------------|----------------|------------------|-----------------|---------|
| PDB1003100MZF | 10 | 1V/100KHz | 35.0 | 110 | 2.00 |
| PDB1003150MZF | 15 | 1V/100KHz | 33.0 | 150 | 1.50 |
| PDB1003220MZF | 22 | 1V/100KHz | 25.0 | 230 | 1.30 |
| PDB1003330MZF | 33 | 1V/100KHz | 19.0 | 300 | 1.10 |
| PDB1003470MZF | 47 | 1V/100KHz | 14.0 | 390 | 0.80 |
| PDB1003680MZF | 68 | 1V/100KHz | 12.0 | 660 | 0.70 |
| PDB1003101MZF | 100 | 1V/100KHz | 10.0 | 840 | 0.60 |
| PDB1003151MZF | 150 | 1V/100KHz | 8.0 | 1200 | 0.50 |
| PDB1003221MZF | 220 | 1V/100KHz | 6.0 | 1900 | 0.40 |
| PDB1003331MZF | 330 | 1V/100KHz | 5.0 | 2700 | 0.30 |
| PDB1003471MZF | 470 | 1V/100KHz | 4.0 | 4000 | 0.20 |
| PDB1003681MZF | 680 | 1V/100KHz | 3.0 | 5300 | 0.10 |
| PDB1003102MZF | 1000 | 1V/100KHz | 2.5 | 8400 | 0.05 |

NOTE: Specifications subject to change without notice. Please check our website for latest information.

7. Characteristics Curves

@ TEMP. RISE VS. DC SUPERPOSITION RESPONSE CURVE

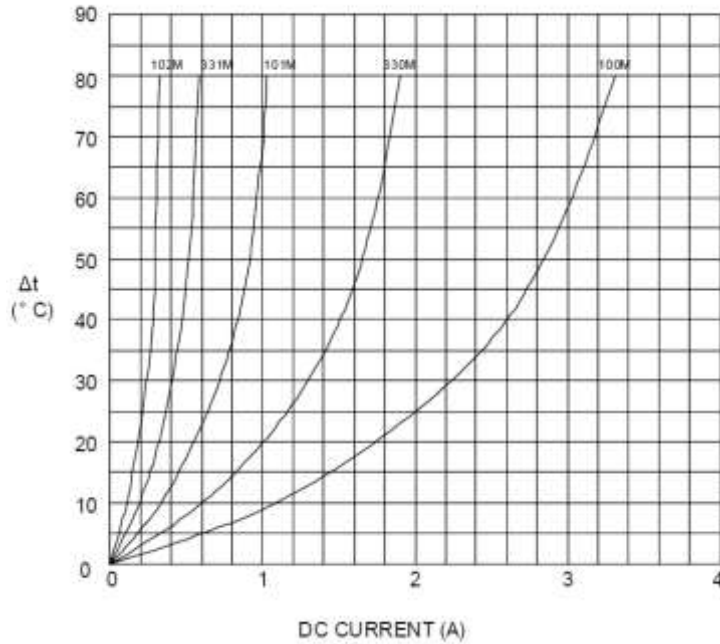

@ INDUCTANCE VS. FREQUENCY RESPONSE CURVE

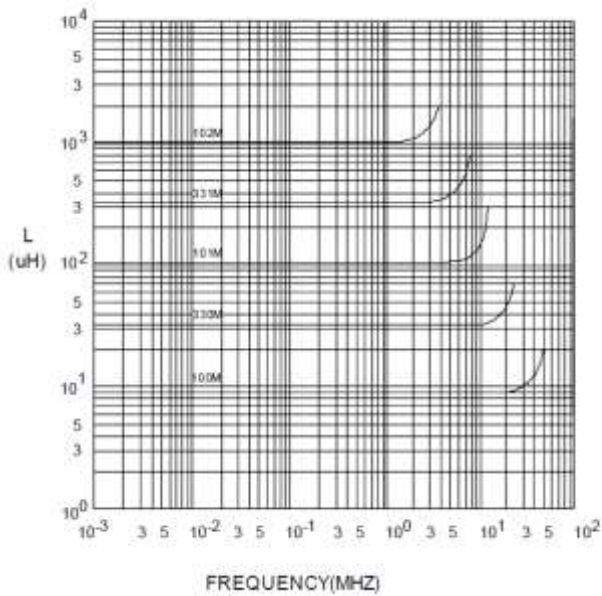

@ INDUCTANCE VS. DC SUPERPOSITION RESPONSE CURVE

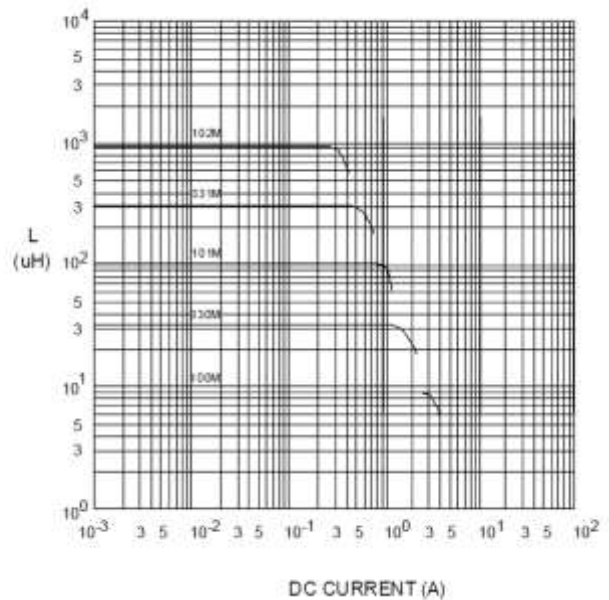

NOTE: Specifications subject to change without notice. Please check our website for latest information.

8. Soldering Specification

Mildly activated rosin fluxes are preferred. Our terminations are suitable for re-flow soldering systems. If hand soldering cannot be avoided, the preferred technique is the utilization of hot air soldering tools.

8-1. IR Soldering Reflow

Recommended temperature profiles for lead free re-flow soldering in Figure 1, Table 1.1 & 1.2 (J-STD-020F).

8-2. Iron Reflow

Products attachment with a soldering iron is discouraged due to the inherent process control limitations. In the event that a soldering iron must be employed the following precautions are recommended (Figure 2).

Note:

- (a) Preheat circuit and products to 150°C.
- (b) 350°C tip temperature (Max.)
- (c) Never contact the ceramic with the iron tip
- (d) 1.0mm tip diameter (Max.)
- (e) Use a 20 watt soldering iron with tip diameter of 1.0mm
- (f) Limit soldering time to 4~5 sec.

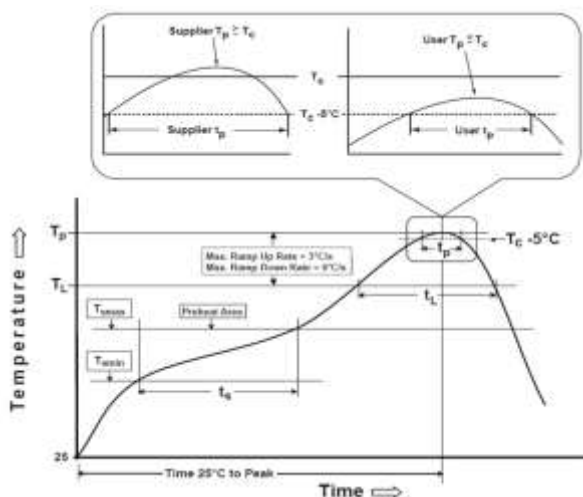

Reflow times: 3 times Max
Figure 1: IR Soldering Reflow

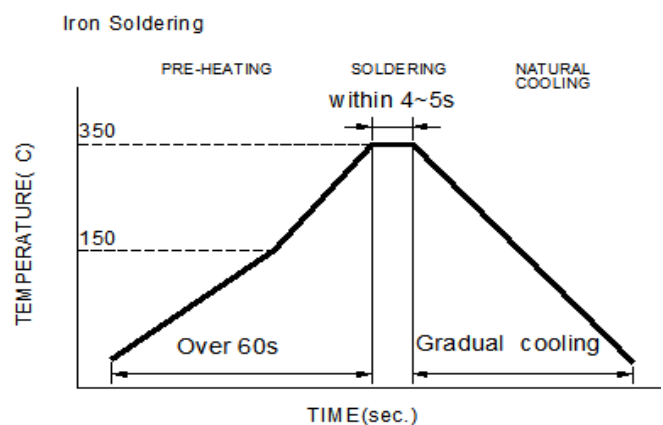

Iron Soldering times : 1 times max
Figure 2: Iron soldering temperature profiles

NOTE: Specifications subject to change without notice. Please check our website for latest information.

Table (1.1) Reflow Profiles

| | |
|--|------------------|
| Profile Type: | Pb-Free Assembly |
| Preheat | |
| -Temperature Min (T_{smin}) | 150°C |
| -Temperature Max (T_{smax}) | 200°C |
| -Time (t_s) from (T_{smin} to T_{smax}) | 60-120seconds |
| Ramp-up rate (T_L to T_p) | 3°C /second max. |
| Liquids temperature (T_L) | 217°C |
| Time (t_L) maintained above T_L | 60-150 seconds |
| Classification temperature (T_c) | See Table (1.2) |
| Time (t_p) at $T_c - 5^\circ\text{C}$ (T_p should be equal to or less than T_c .) | < 30 seconds |
| Ramp-down rate (T_p to T_L) | 6°C /second max. |
| Time 25°C to peak temperature | 8 minutes max. |

T_p: maximum peak package body temperature, **T_c**: the classification temperature.

For user (customer) **T_p** should be equal to or less than **T_c**.

Table (1.2) Package Thickness/Volume and Classification Temperature (T_c)

| | Package Thickness | Volume mm ³ <350 | Volume mm ³ 350-2000 | Volume mm ³ >2000 |
|------------------|-------------------|-----------------------------|---------------------------------|------------------------------|
| PB-Free Assembly | <1.6mm | 260°C | 260°C | 260°C |
| | 1.6-2.5mm | 260°C | 250°C | 245°C |
| | ≥2.5mm | 250°C | 245°C | 245°C |

Reflow is referred to standard IPC/JEDEC J-STD-020F.

8-3. Soldering Volume

Accordingly increasing the solder volume, the mechanical stress to product is also increased. Exceeding solder volume may cause the failure of mechanical or electrical performance. Solder shall be used not to be exceeded as shown in the Figure below. Minimum fillet height = soldering thickness + 25% product height.



NOTE: Specifications subject to change without notice. Please check our website for latest information.

9. Packaging Information

9-1. Reel Dimension (Unit: mm)

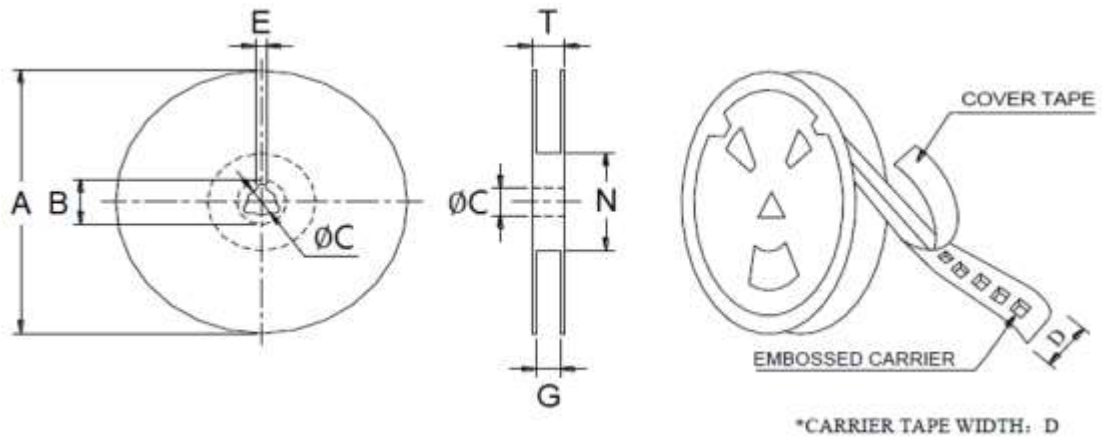

| | | | | |
|----------|-----------|----------|----------|----------|
| Type | A | B | C | D |
| | 330.0 Ref | 21.0 Ref | 13.0 Ref | 24.0 Ref |
| 13"x24mm | E | G | N | T |
| | 2.0 Ref | 26.0 Max | 50.0 Min | 30.4 Ref |

9-2. Tape Dimension (Unit: mm)

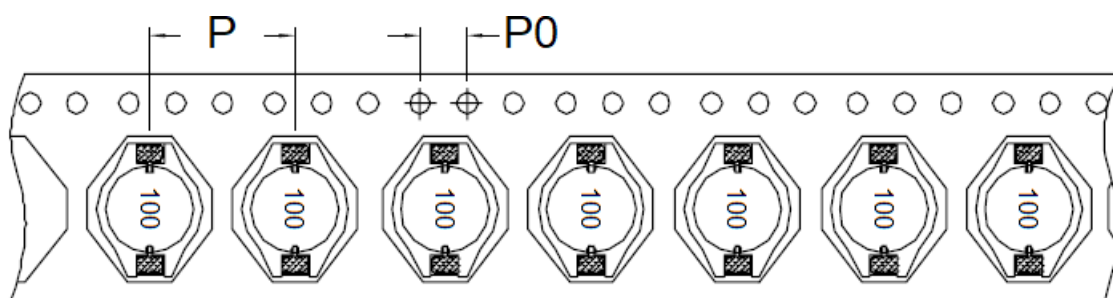

| | |
|----|----|
| P | P0 |
| 16 | 4 |

NOTE: Specifications subject to change without notice. Please check our website for latest information.

9-3. Packaging Type

| INNER : REEL | | | OUTER : CARTON | | |
|--------------|-----------|-------|----------------|-----------|--------------|
| Q'TY(PCS) | G.W. (gw) | STYLE | Q'TY(PCS) | G.W. (Kg) | SIZE(cm) |
| 1,000 | 950 | 13-24 | 4,000 | 7.3 | 40 x 40 x 24 |

9-4. Tearing Off Force

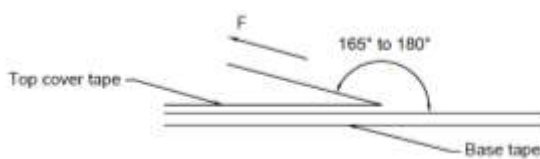

The force for tearing off cover tape is according to the follow table, in the arrow direction under the following conditions.

(Referenced ANSI/EIA-481-D-2008 of 4.11 standard)

| Room Temp. (°C) | Room Humidity (%) | Room atm (hPa) | Tearing Speed (mm/min) |
|-----------------|-------------------|----------------|------------------------|
| 5~35 | 45~85 | 860~1060 | 300±10 |

| Tape Size | 8 mm | 12 to 56 mm | 72 mm or Wider |
|---------------------------|--------|-------------|----------------|
| Tearing Off Force (grams) | 10~100 | 10~130 | 10~150 |

Application Notice

1. Storage Conditions

To maintain the solderability of terminal electrodes:

- (a) Products meet IPC/JEDEC J-STD-020F standard-MSL, level 1.
- (b) Recommended products should be used within 12 months from the time of delivery.
- (c) The packaging material should be kept where no chlorine or sulfur exists in the air.

2. Transportation

- (a) Products should be handled with care to avoid damage or contamination from perspiration and skin oils.
- (b) Vacuum pick up is strongly recommended for individual components.
- (c) Bulk handling should ensure that abrasion and mechanical shock are minimized.

NOTE: Specifications subject to change without notice. Please check our website for latest information.